

KEY MAP SECONDO PIANO INTERRATO / KEY MAP NIVEAU B2

IDENTIFICAZIONE MATERIALI LIVELLO B2, PAVIMENTI / IDENTIFICATION DU MATERIAUX NIVEAU B2, PAVAGES

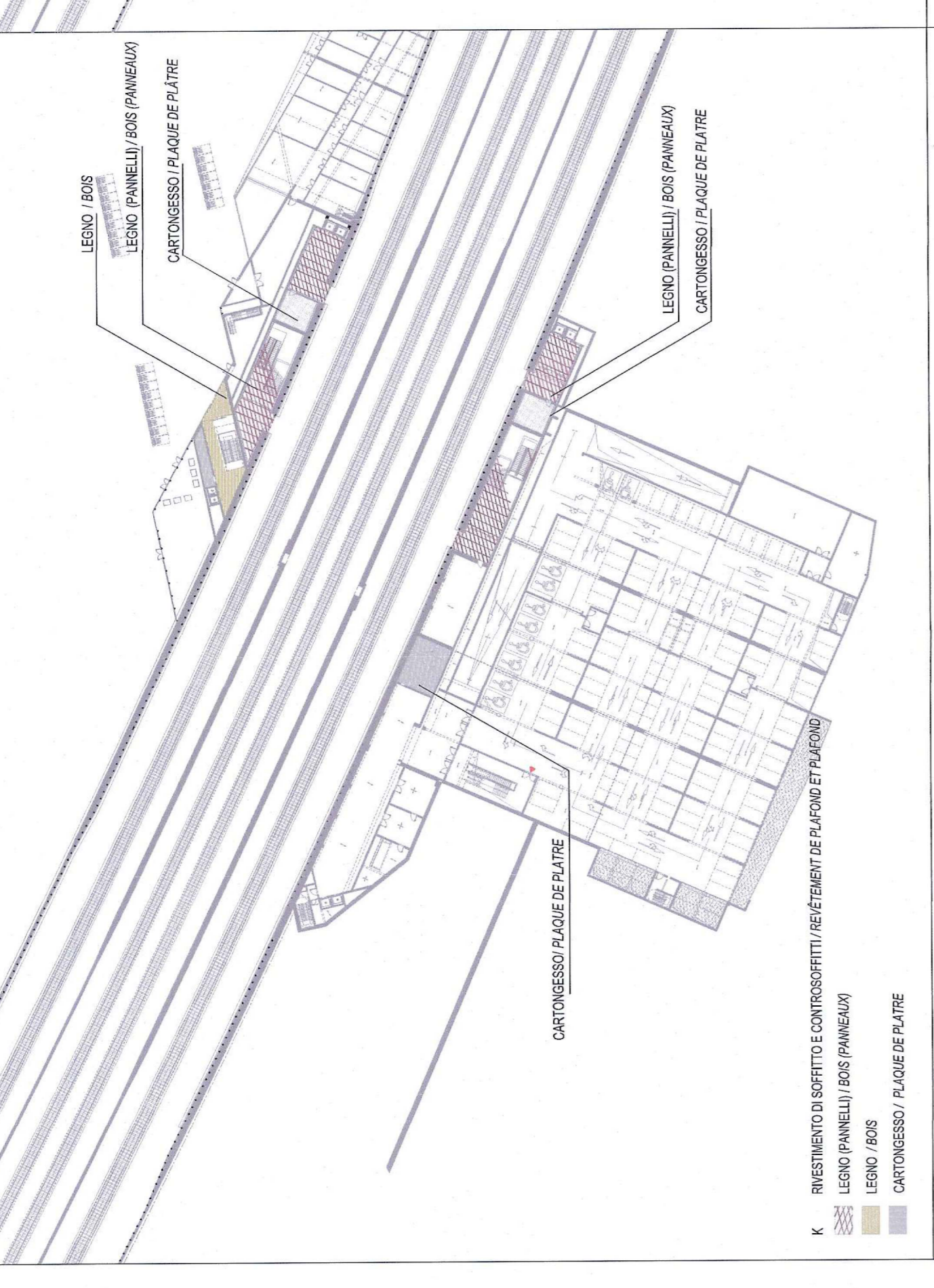

LEGENDA MATERIALI DI FINITURA / PRINCIPAUX MATERIAUX DE FINITION

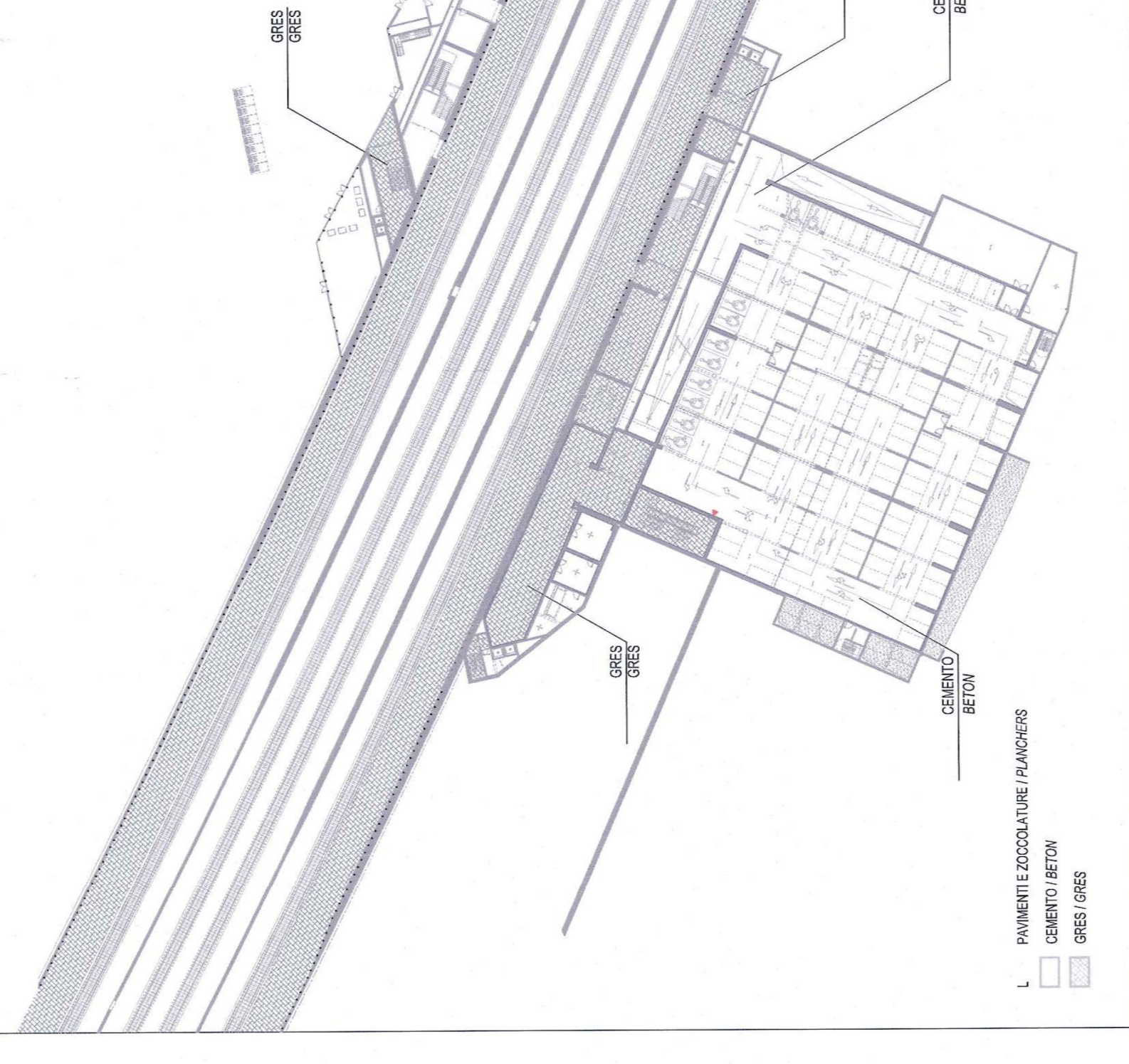

KEY MAP PIANO TERRA / KEY MAP PLAN REZ DE CHAUSSEE

IDENTIFICAZIONE MATERIALI PIANO TERRA, CONTROSOFFITTI

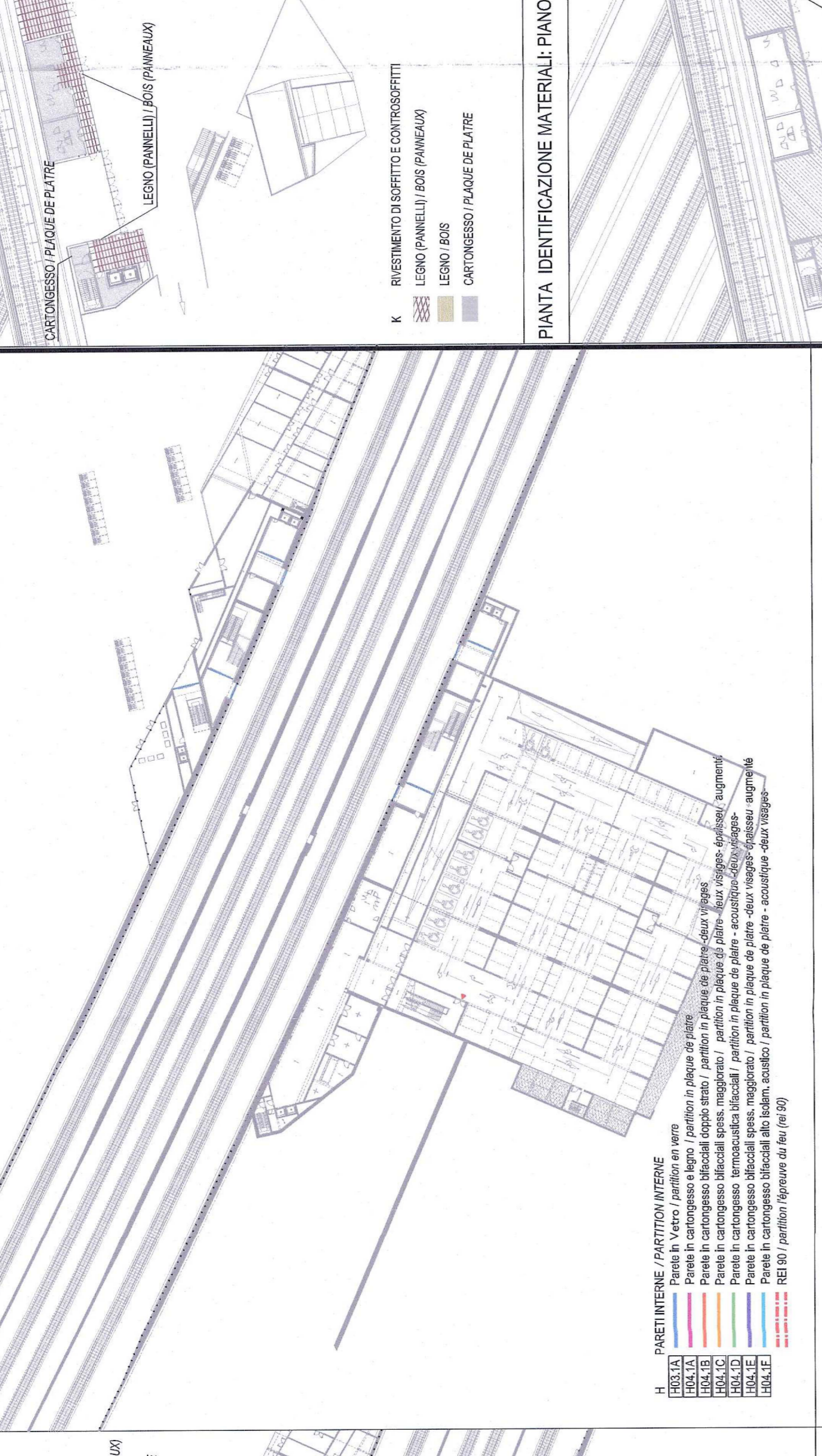

LEGENDA MATERIALI DI FINITURA / PRINCIPAUX MATERIAUX DE FINITION

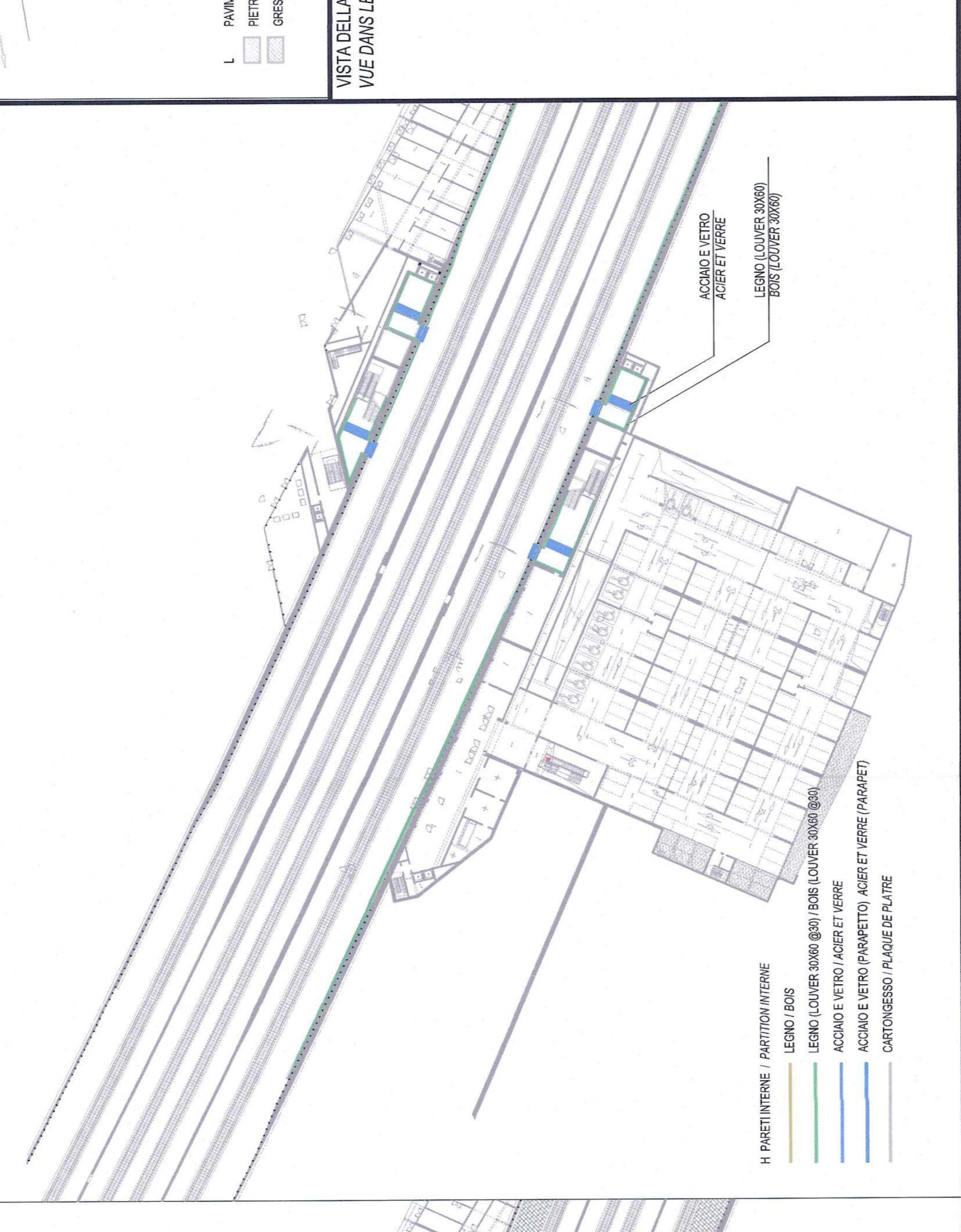

KEY MAP PIANO TERRA / KEY MAP PLAN REZ DE CHAUSSEE

IDENTIFICAZIONE MATERIALI PIANO TERRA, PARETI INTERNE



LEGENDA MATERIALI DI FINITURA / PRINCIPAUX MATERIAUX DE FINITION

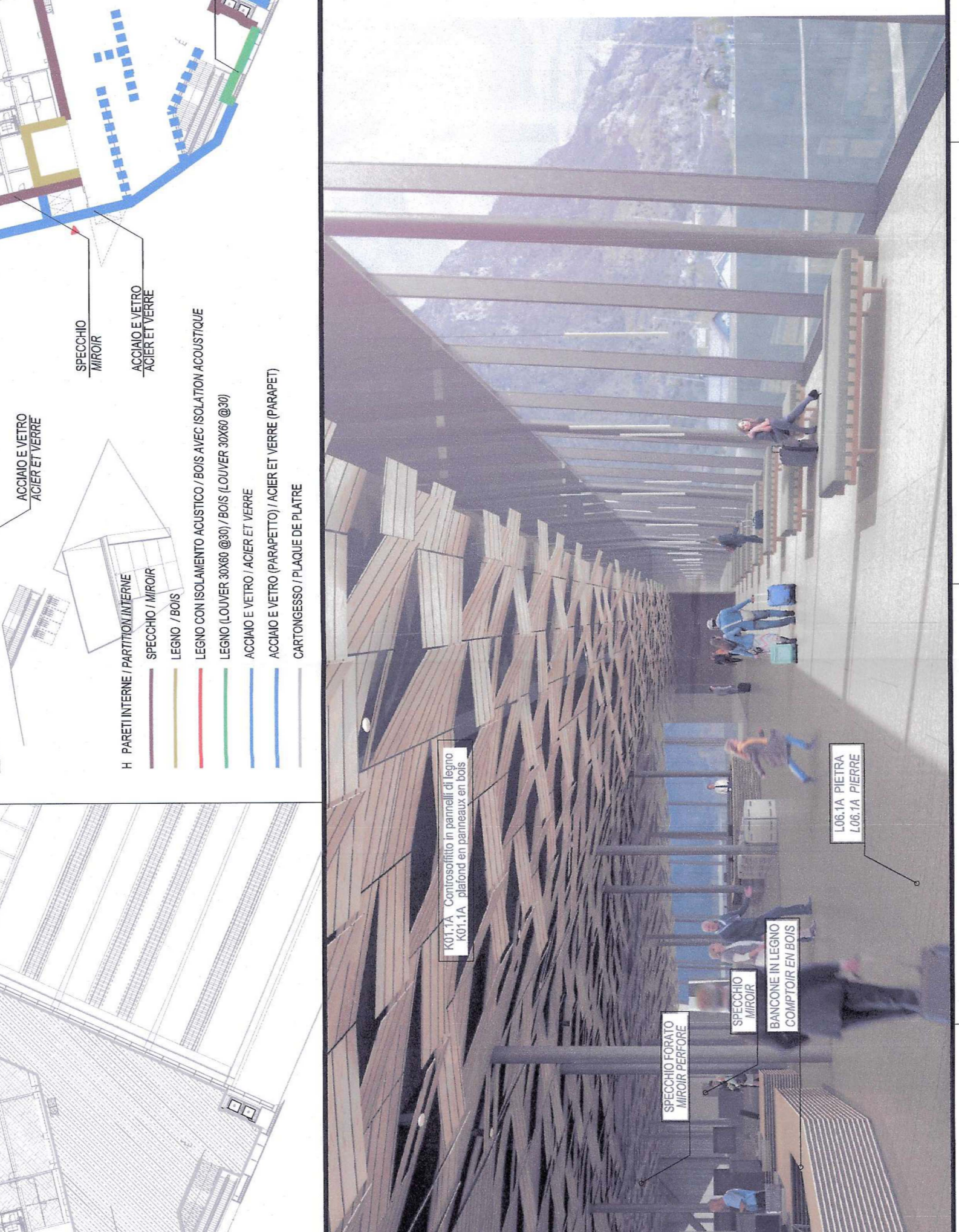

KEY MAP PIANO TERRA / KEY MAP PLAN REZ DE CHAUSSEE

IDENTIFICAZIONE MATERIALI PIANO TERRA, PARETI INTERNE

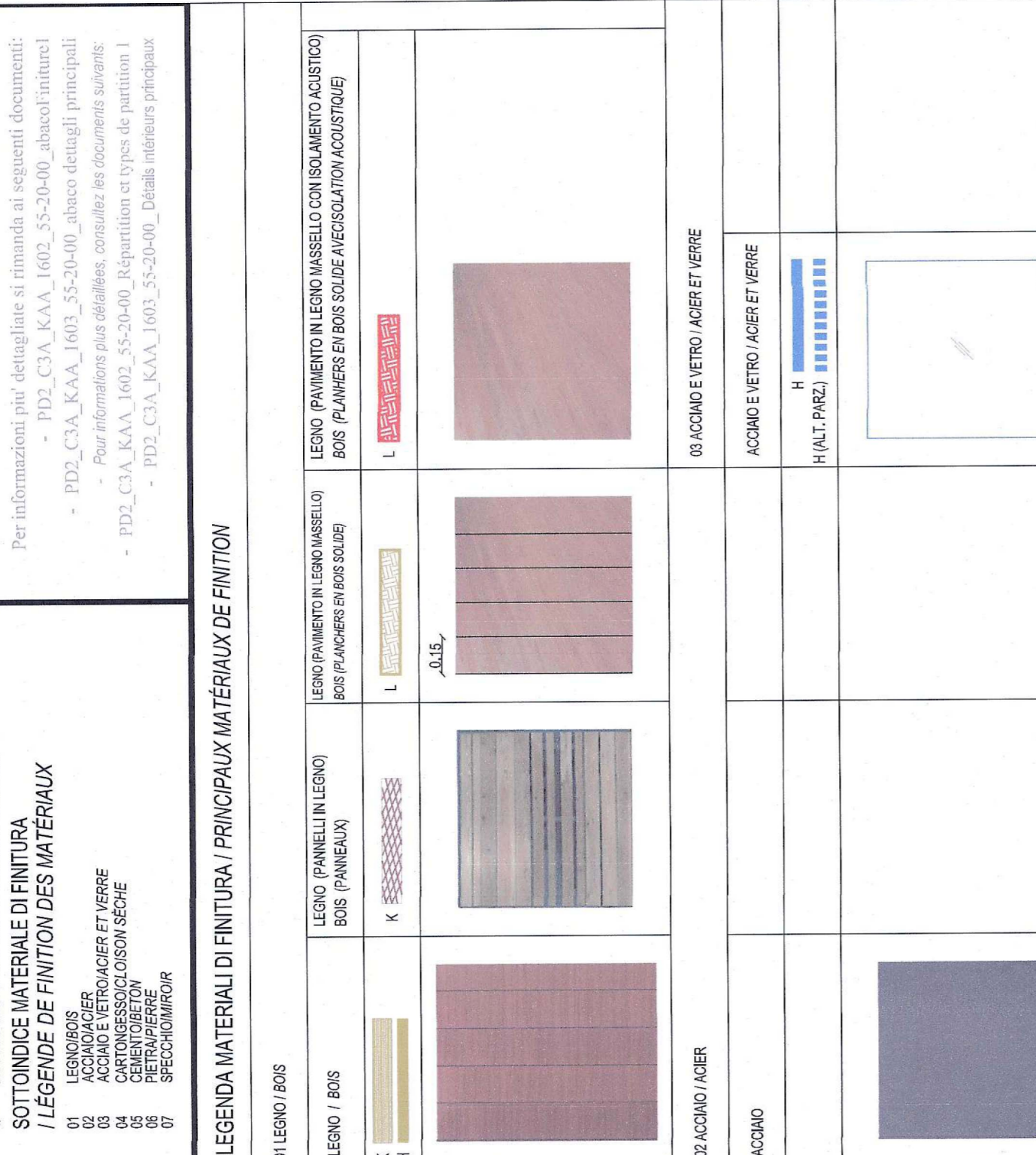

LEGENDA MATERIALI DI FINITURA / PRINCIPAUX MATERIAUX DE FINITION

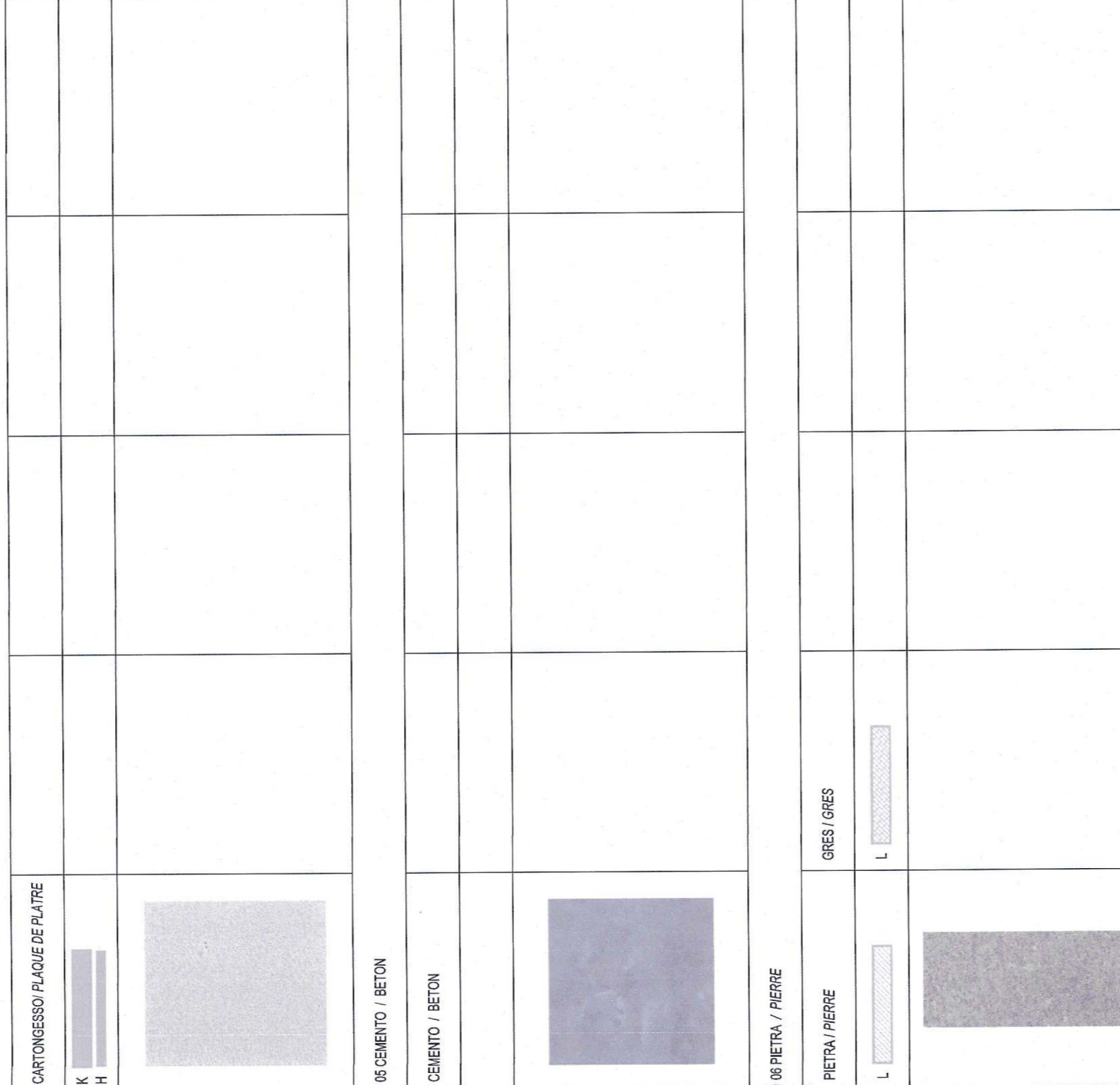

K RIVESTIMENTO SOFFITTO E CONTROSOFFITTI

K RIVESTIMENTI DE PLAFOND

REV.15) controsoffitto in cartongesso

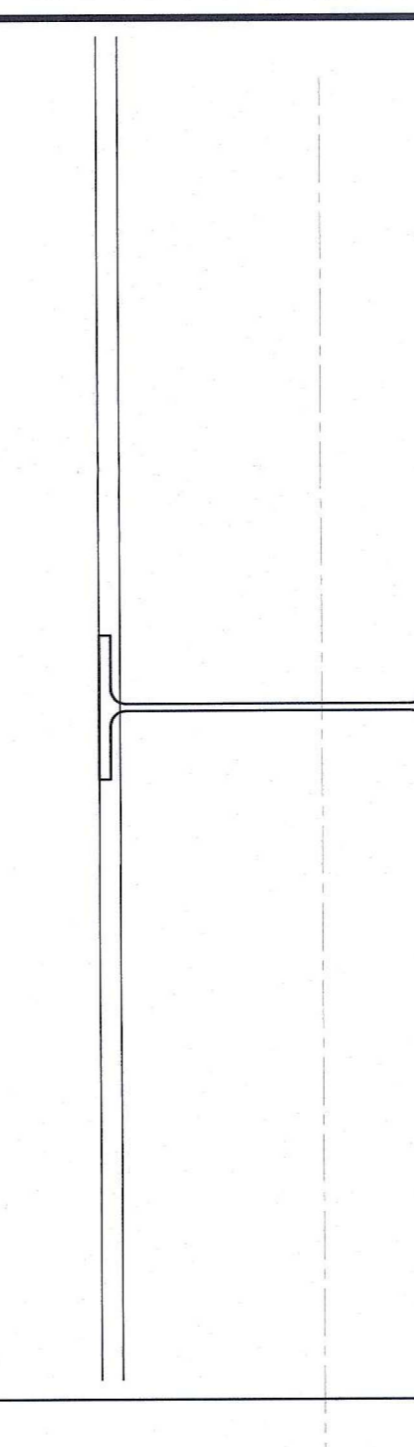

E CHUSURE E RIVESTIMENTI ESTERNI

E REVESTIMENTS EXTERIEURS

EVZ.15) Pannello in scaglie metalliche (SISTEMA COPERTURA)

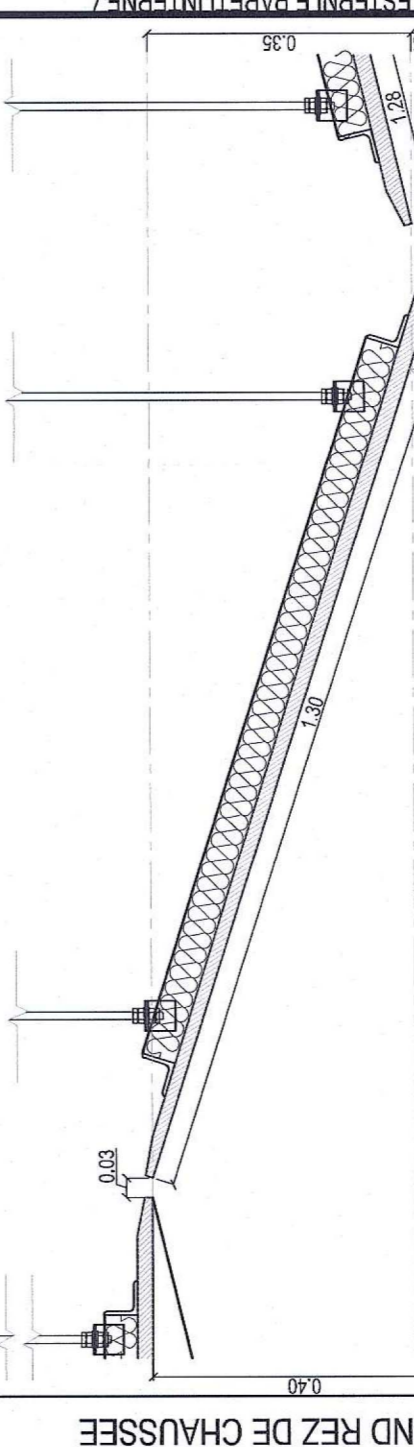

H PARETI INTERNE

H PARTITION INTERNE

EVZ.12) Pannello in vetro

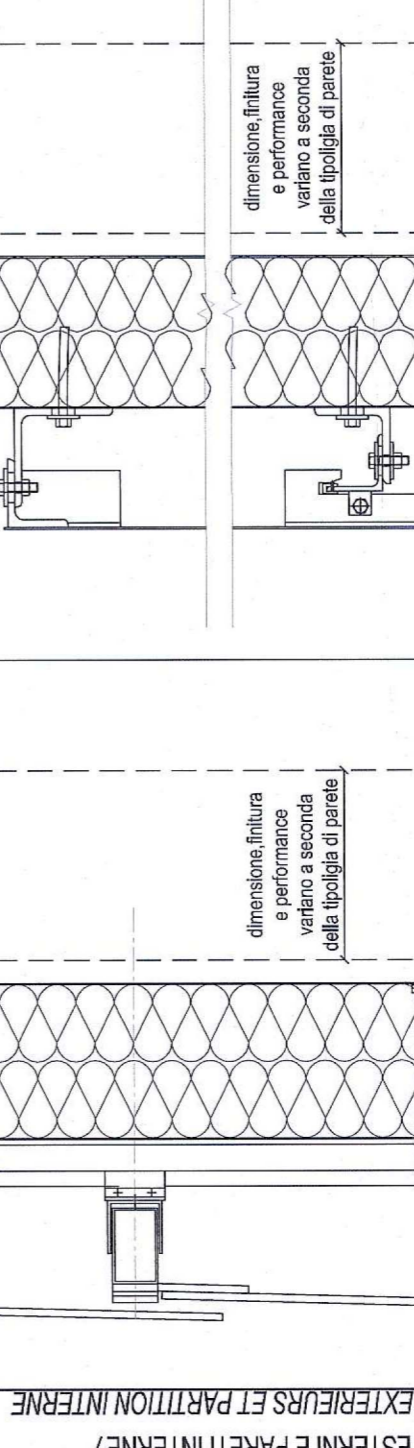

H PARETI INTERNE

H PARTITION INTERNE

EVZ.12) Pannello in cartongesso bifacciale opaco, ingrandito

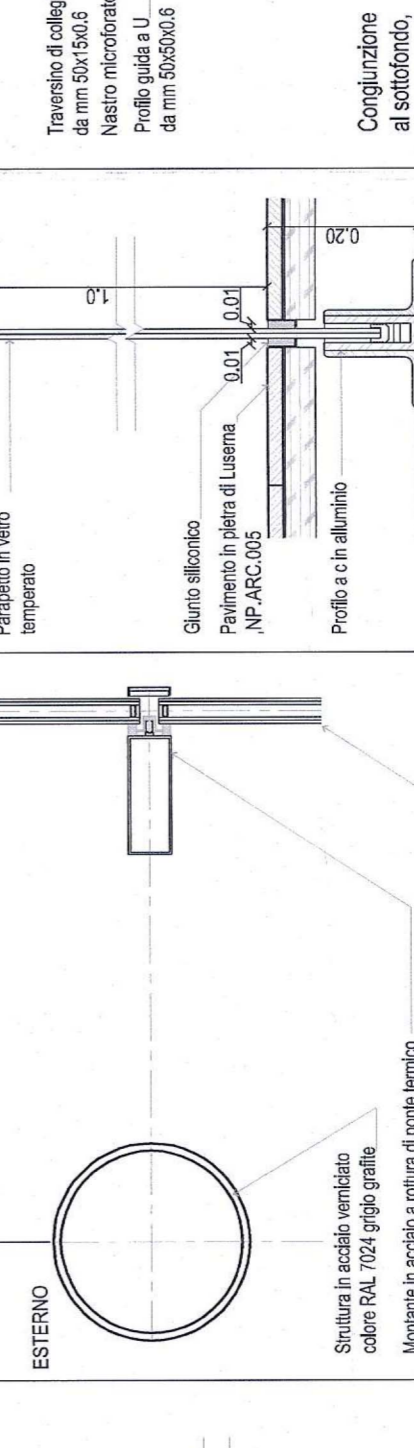

H PARETI INTERNE

H PARTITION INTERNE

EVZ.12) Pannello in cartongesso bifacciale opaco, ingrandito

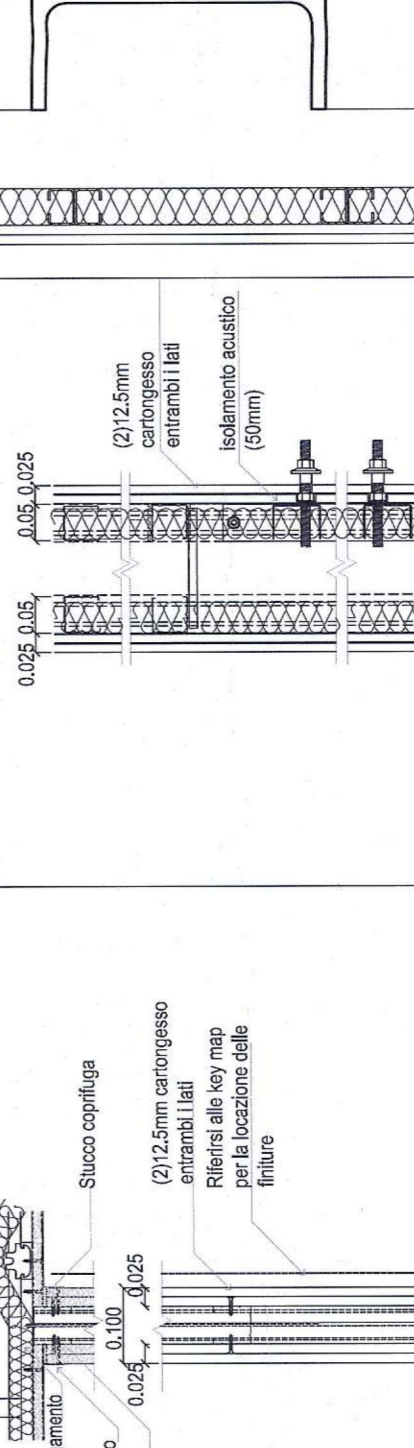

H PARETI INTERNE

H PARTITION INTERNE

EVZ.12) Pannello in cartongesso bifacciale opaco, ingrandito

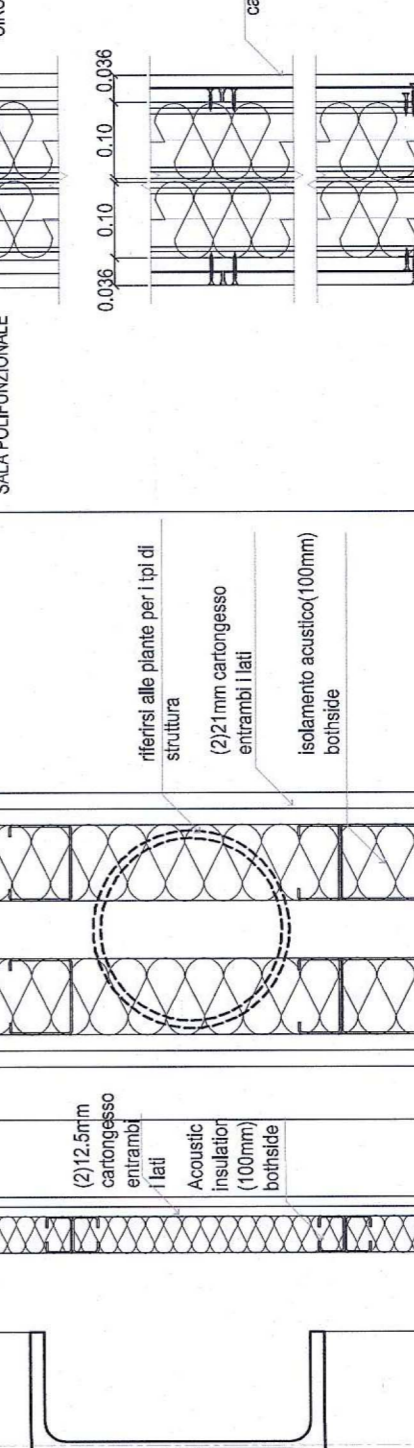

L PAVIMENTI ZOCOLATURE

L PAVAGES

EVZ.11) Pietra

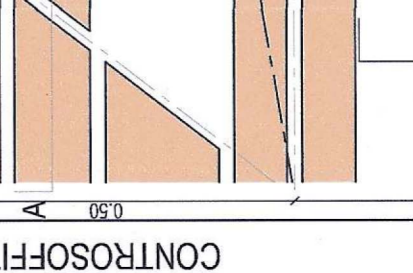

L PAVIMENTI ZOCOLATURE

L PAVAGES

EVZ.11) Legno

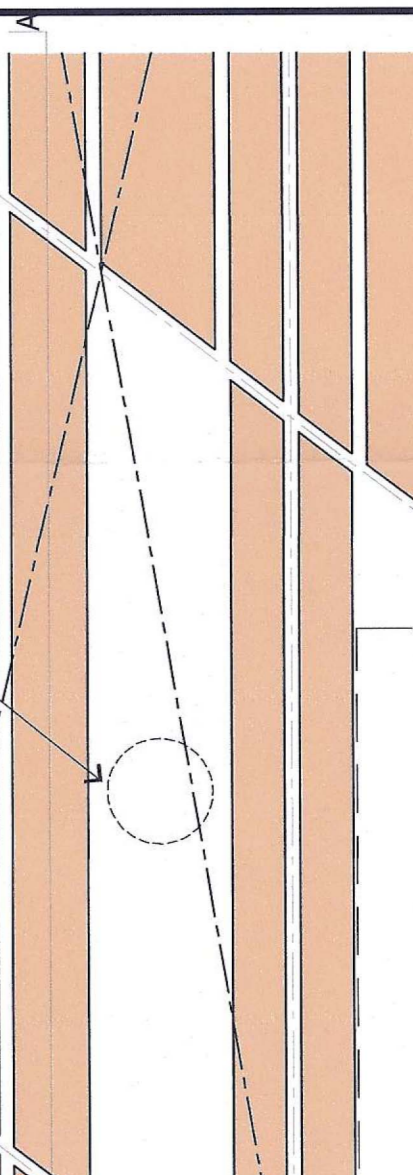

L PAVIMENTI ZOCOLATURE

L PAVAGES

EVZ.11) Legno

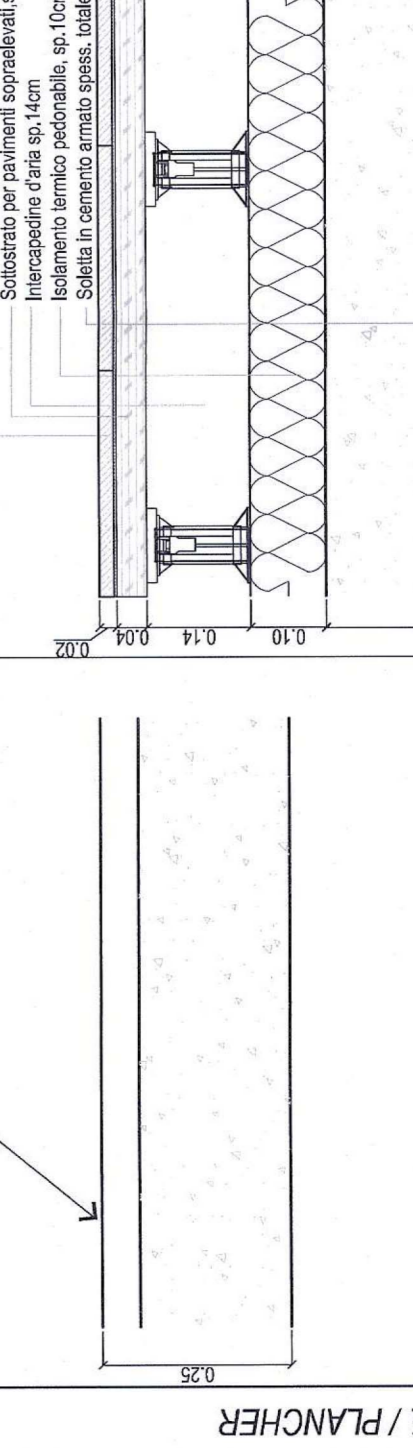

L PAVIMENTI ZOCOLATURE

L PAVAGES

EVZ.11) Legno

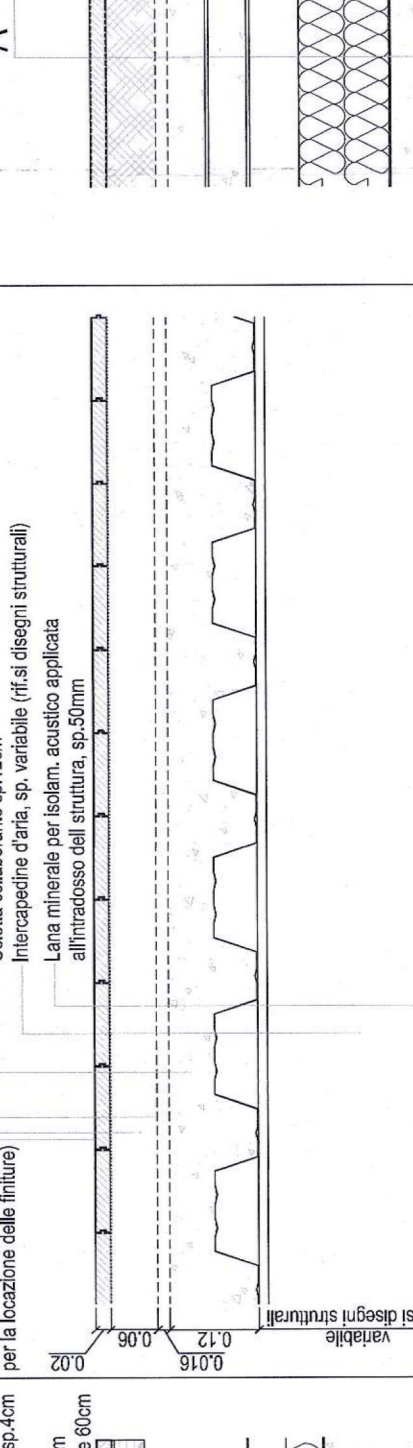

L PAVIMENTI ZOCOLATURE

L PAVAGES

EVZ.11) Legno

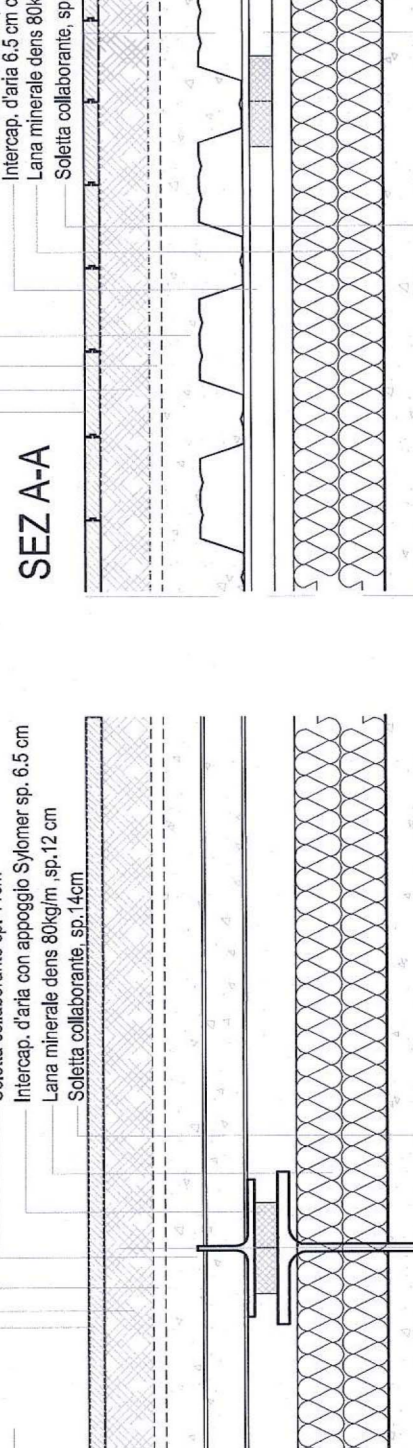

L PAVIMENTI ZOCOLATURE

L PAVAGES

EVZ.11) Legno



L PAVIMENTI ZOCOLATURE

L PAVAGES

EVZ.11) Legno

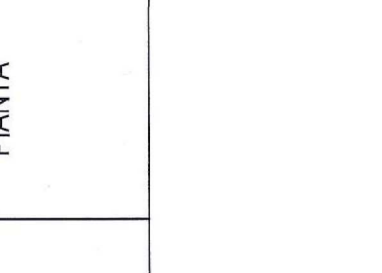

L PAVIMENTI ZOCOLATURE

L PAVAGES

EVZ.11) Legno

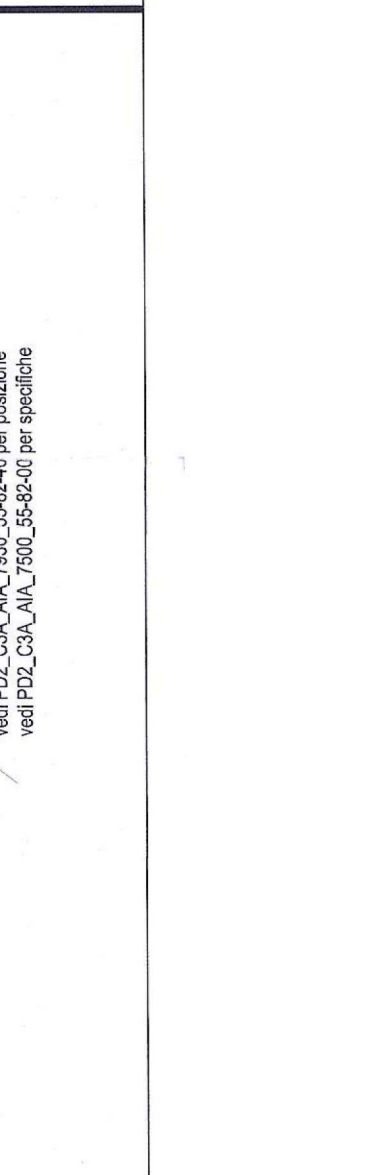

L PAVIMENTI ZOCOLATURE

L PAVAGES

EVZ.11) Legno

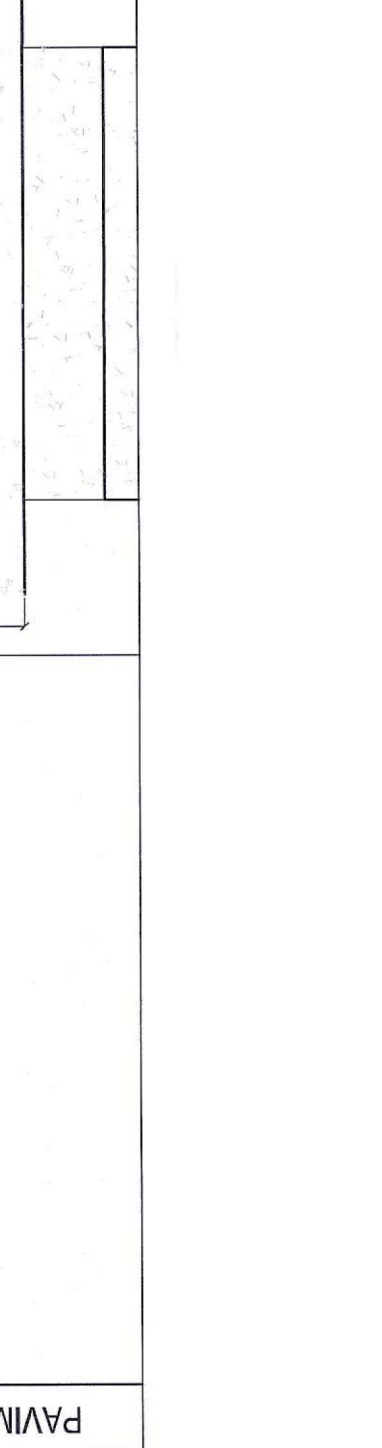

L PAVIMENTI ZOCOLATURE

L PAVAGES

EVZ.11) Legno

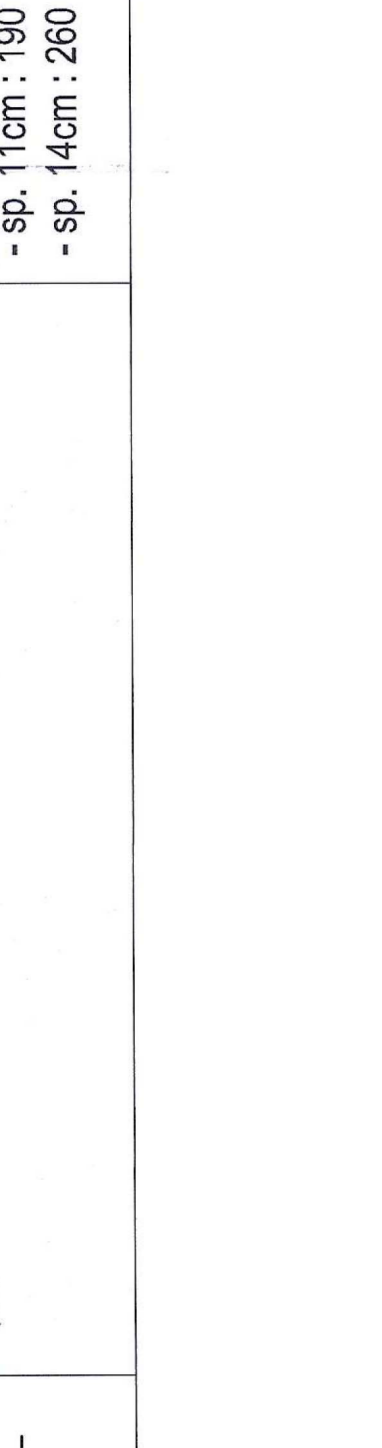

L PAVIMENTI ZOCOLATURE

L PAVAGES

EVZ.11) Legno

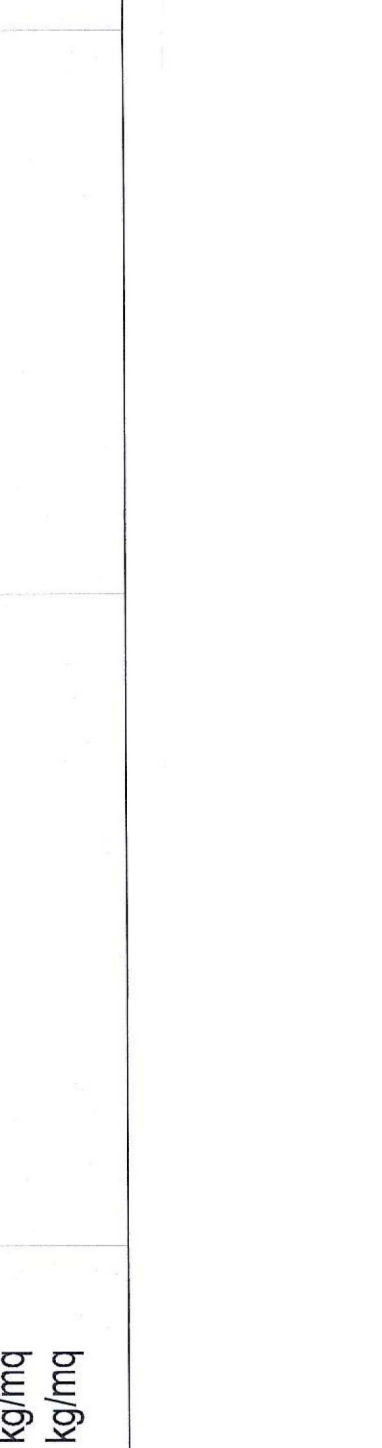

L PAVIMENTI ZOCOLATURE

L PAVAGES

EVZ.11) Legno

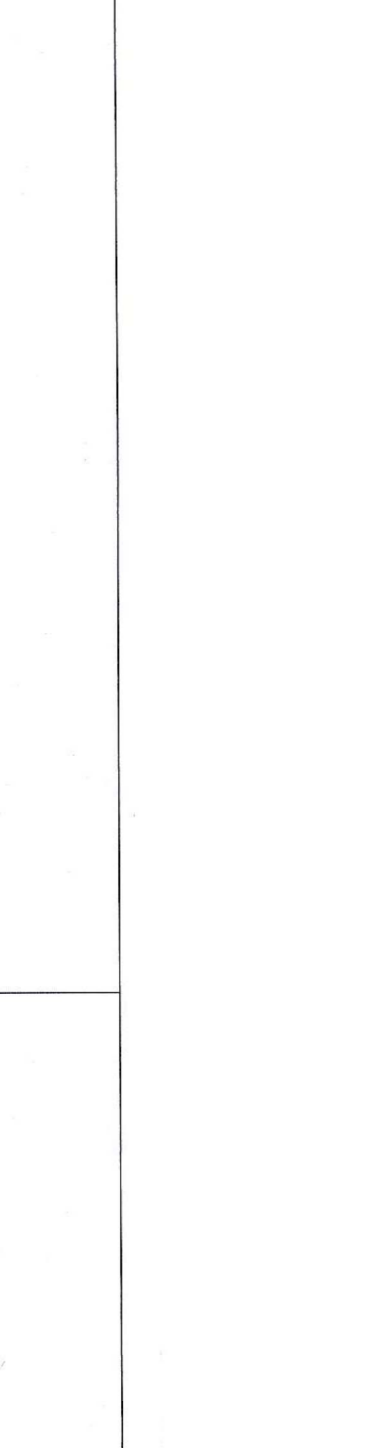

Nota: peso superficiale della soletta collaborante
-sp: 1cm: 100 kg/mq
-sp: 1cm: 200 kg/mq

TAISON LYON - TURIN / COLLEGAMENTO TORINO - LIONE
Partis communs franco-italienne
Section transfrontalière

NOUVELLE LIGNE LYON TURIN - NUOVA LINEA TORINO LIONE
PARTIE COMMUNE FRANCO-ITALIENNE - PARTE COMUNE ITALO-FRANCESE
REVISION DE L'AVANT-PROJET DE REFERENCE - REVISIONE DEL PROGETTO DEFINITIVO
CUP C11U9500000001

STAZIONE INTERNAZIONALE E SUILO D'INTERCAMBIARE INTERNAZIONALE DES SENS ET SENS-POLE DE CHANGE
Atacco finitura / Répartition des finitions 1

DATA	DESCRIZIONE	REDAZIONE
07/12/12	prima diffusione	Masakuni Yokotani
07/10/13	presa in conto dei commenti LTF	Nicola Maniero
31/10/13	presa in conto dei commenti LTF e CDF	Masakuni Yokotani

REDAZIONE: ARCADIA ASSOCIATES S.p.A.
PROGETTAZIONE: ARCADIA ASSOCIATES S.p.A.

CA - 95 20 00 60 01
ESCALE N. 1001
VARIÉ

L'IT è - 1001 Avenue de la Soie - BPERNOL-72008 - CHAMBERY
Tel. +33 (0) 4 78 68 82 80 - Fax +33 (0) 4 78 68 82 79
www.itp.it
PROJET: L'IT pour la liaison internationale - Turin-Lyon - Lyon-Turin