

DIAGONALI DI CONTROVENTAMENTO SUPERIORI TRATTO A LARGHEZZA COSTANTE  
PIANTA  
scala 1:50

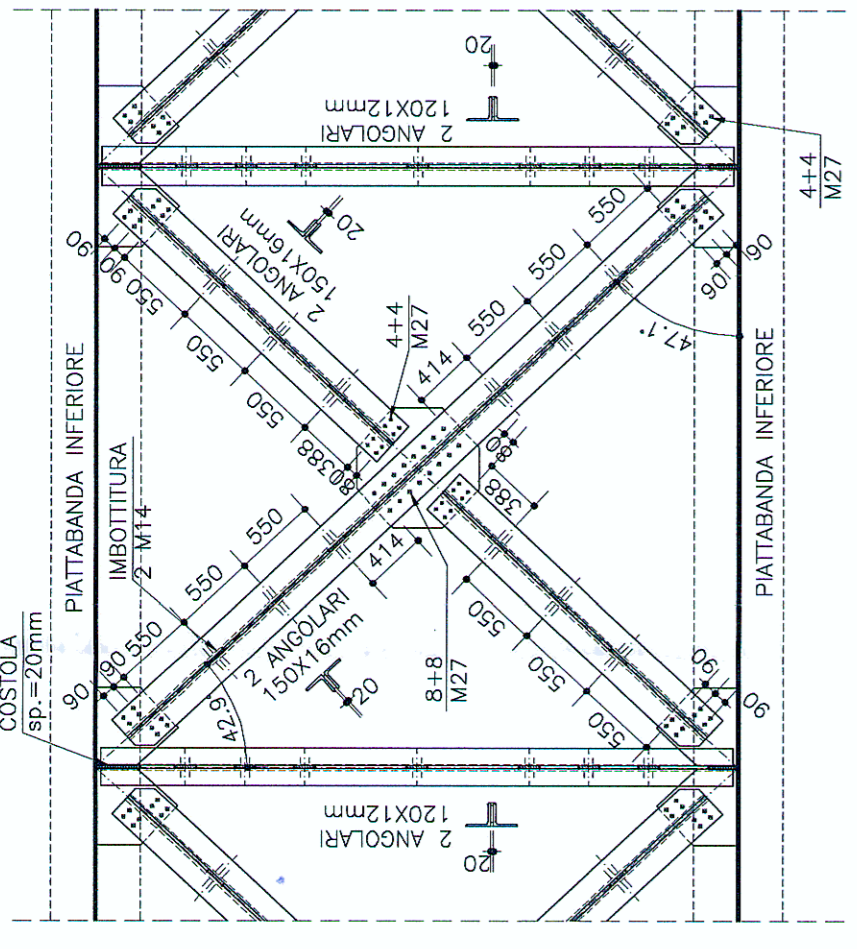

DIAGONALI DI CONTROVENTAMENTO INFERIORI TRATTO A LARGHEZZA COSTANTE  
PIANTA  
scala 1:50



DIAGONALI DI CONTROVENTAMENTO SUPERIORI PILA P10  
PIANTA  
scala 1:50

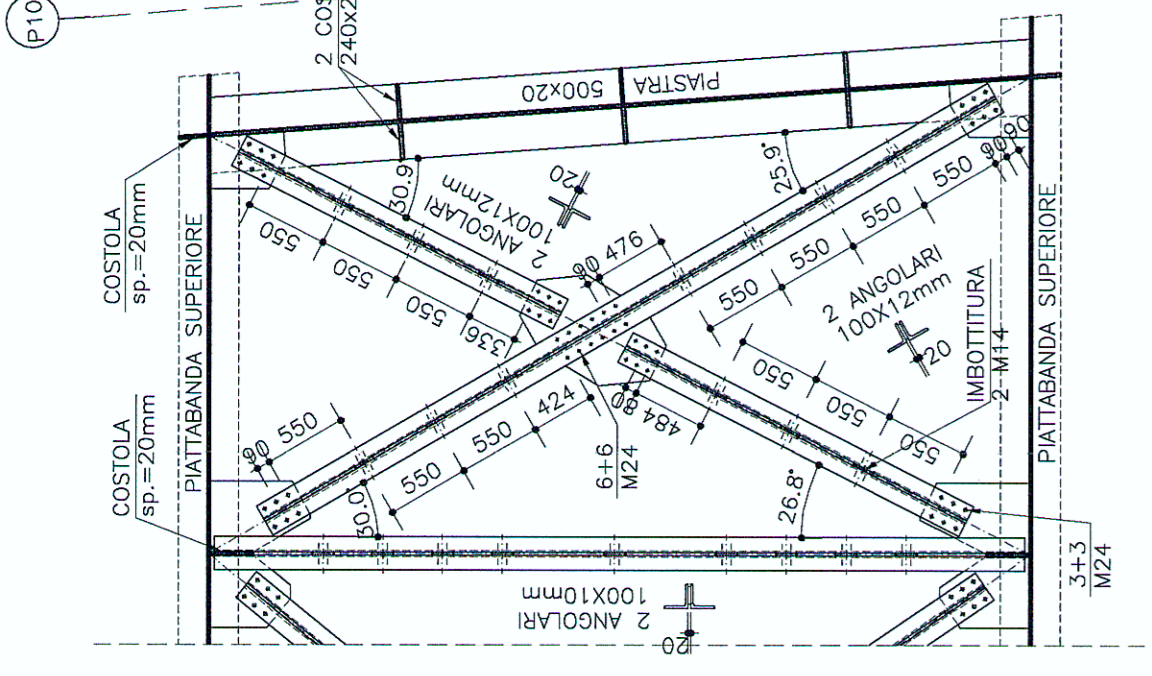

DIAGONALI DI CONTROVENTAMENTO INFERIORI PILA P10  
PIANTA  
scala 1:50

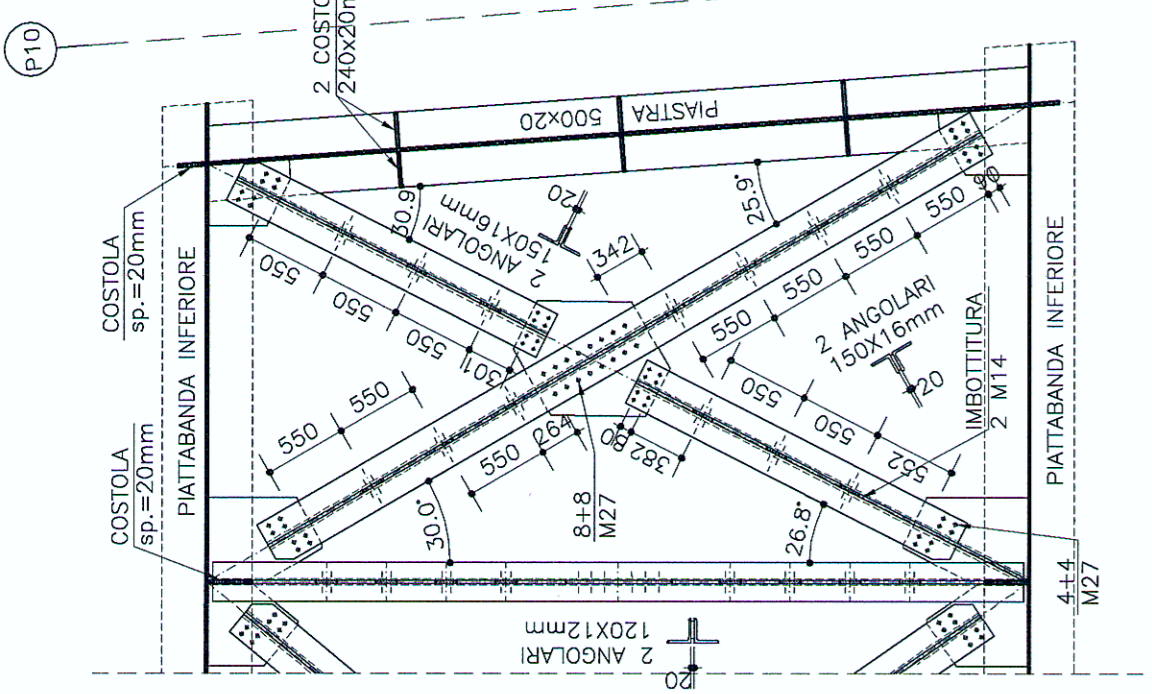

TRAVESSO INTERMEDIO TRATTO A LARGHEZZA COSTANTE

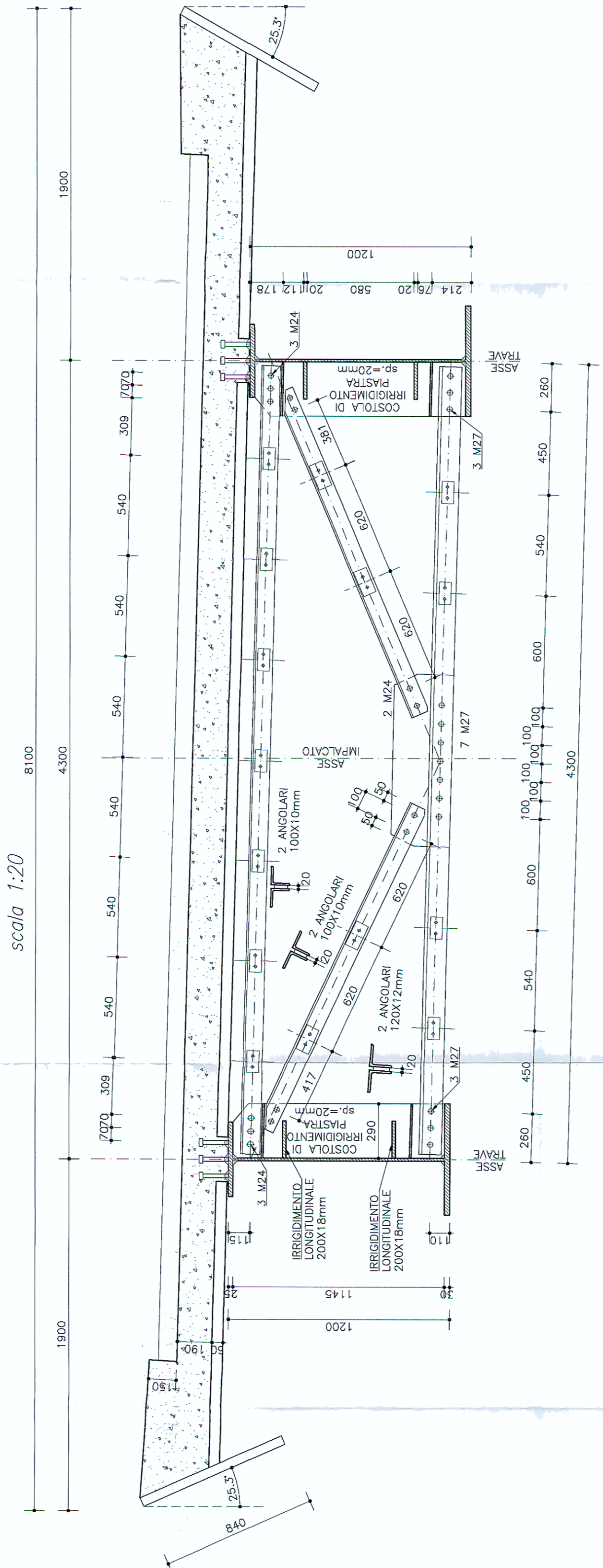

DIAFRAMMA PIENO PILA P9

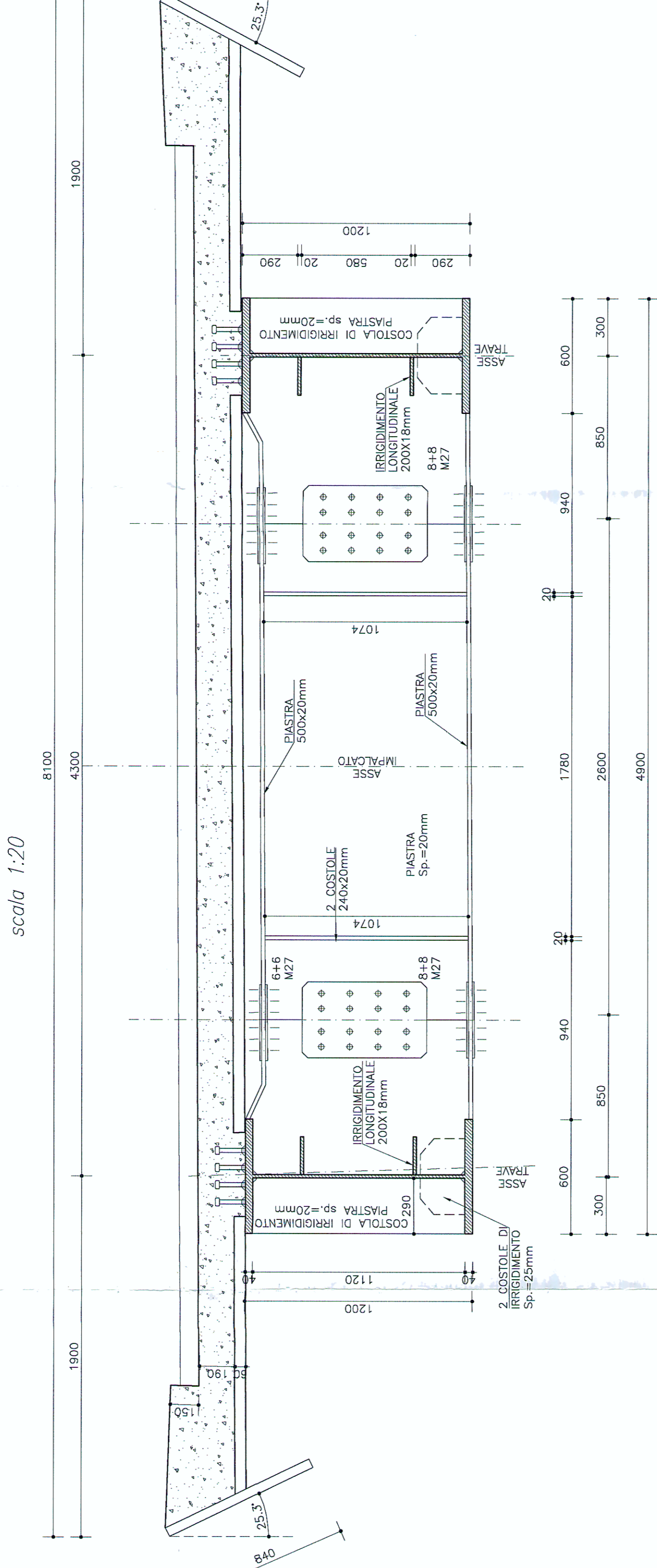

TRAVESSO DI TESTATA S3

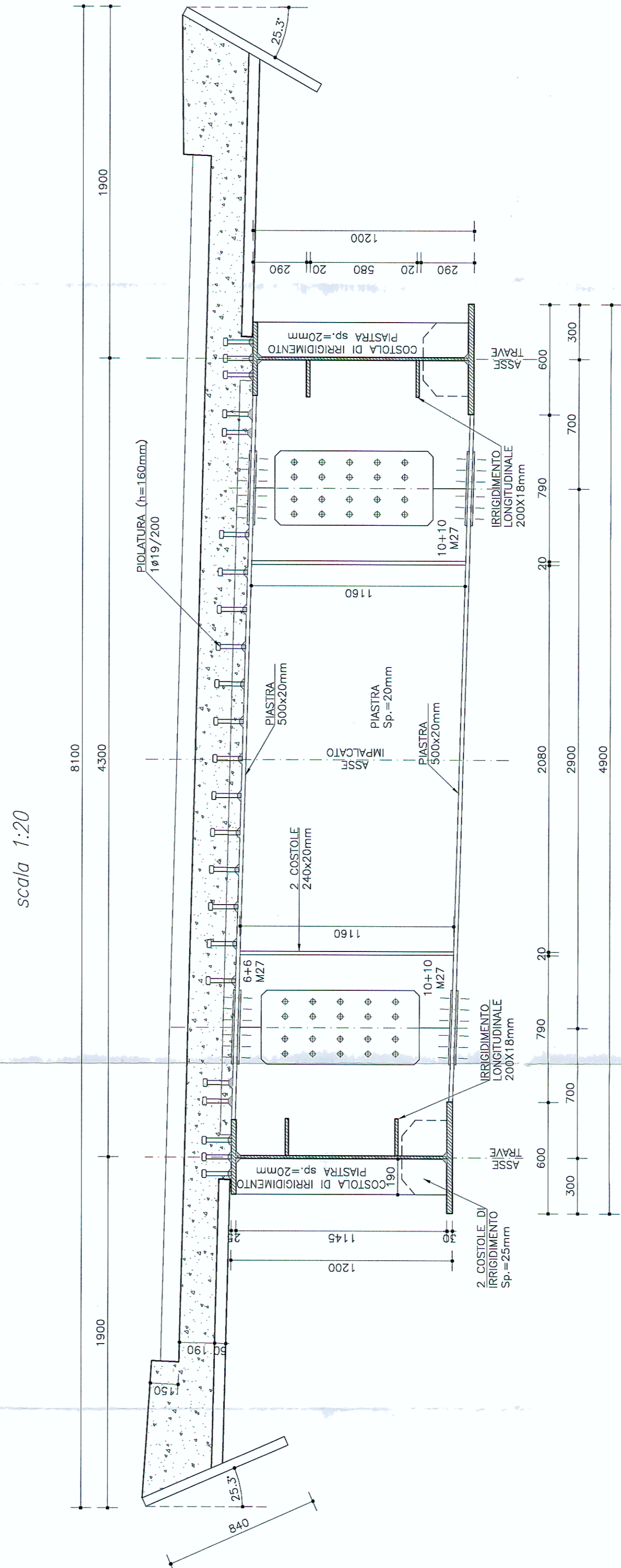

TRAVESSO DI TESTATA P10

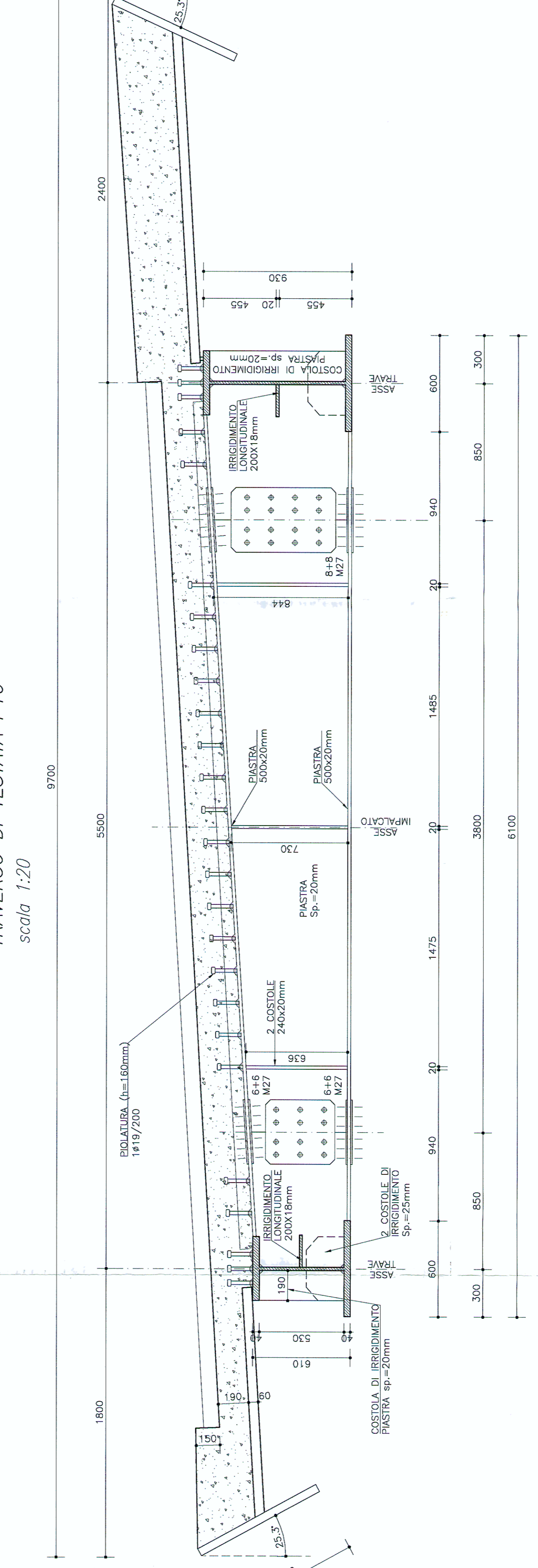

DIAFRAMMA PIENO PILA P8

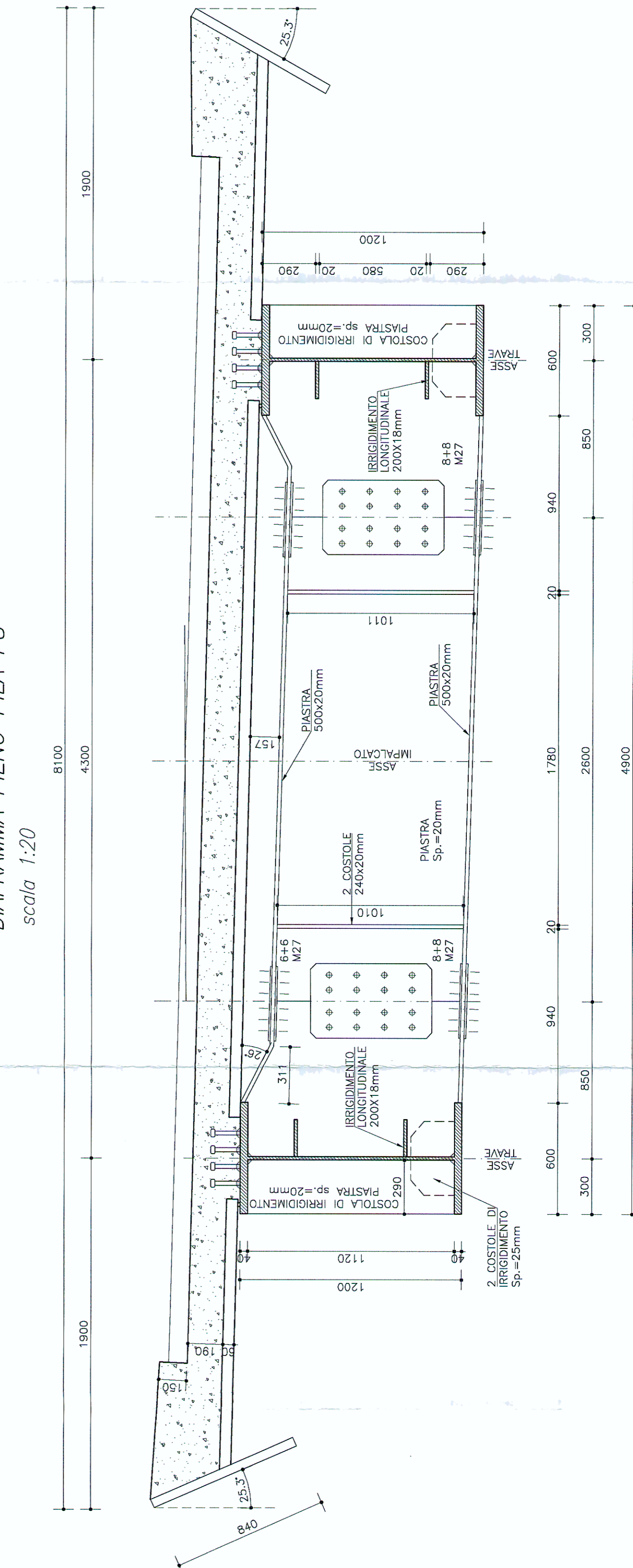

TRAVESSO INTERMEDIO TRATTO A LARGHEZZA VARIABILE

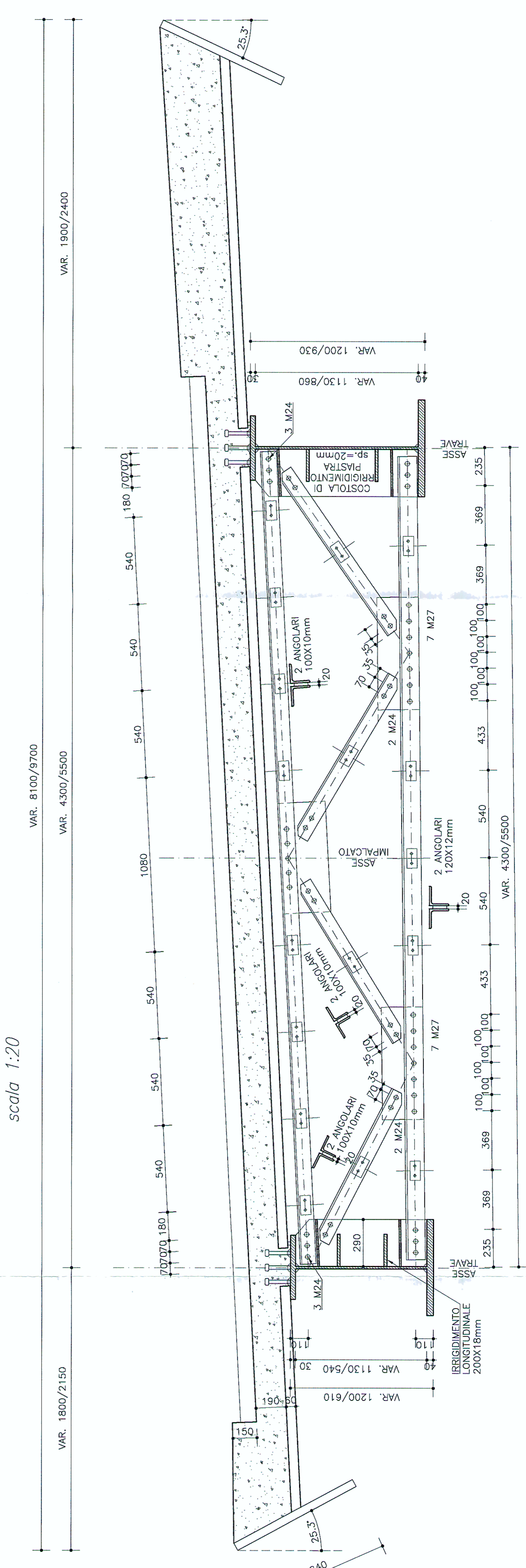

CARATTERISTICHE DEI MATERIALI (conformi a D.M. 14.01.2008)

Table with 5 columns: CLASSI DI CALCESTRUZZO, CLASSI DI ACCIAIO, CLASSI DI BULLONI, CLASSI DI MATERIALI DI FINEZZA, and CLASSI DI MATERIALI DI GRANULARITÀ. It lists various material specifications and their corresponding standards.

REQUISITI / REFERENCES: P10, C24, MUS 1501, D.P.A. NOTI-Sorvegliato di Ingegneria, Riforma-Reazione di calcolo. Includes details about the structural analysis and design process.

Project information block including logos for STAF S.p.A. and SOCIETÀ ITALIANA TRAFORO AUTOSTRADALE DEL FREJUS, project name 'RILOCALIZZAZIONE DELL'AUTOPORTO DI SUSA', and a grid of design and approval stamps.