

DIAGONALI DI CONTROVENTAMENTO SUPERIORI TRATTO A LARGHEZZA COSTANTE
PIANTA
scala 1:50

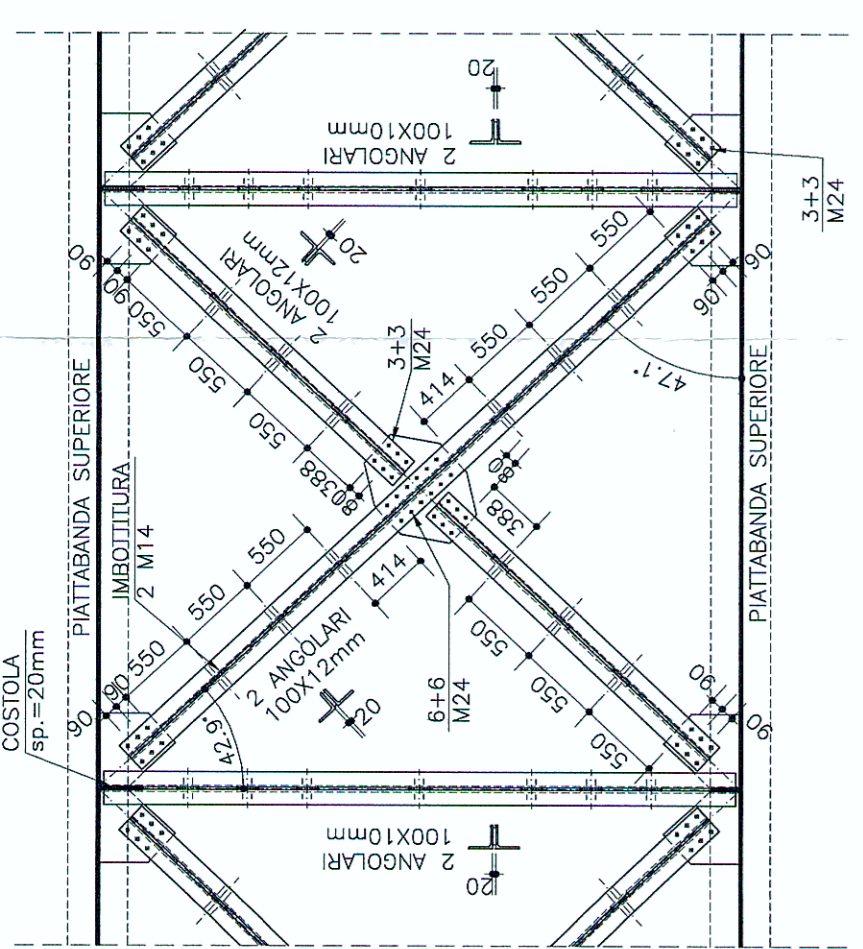

DIAGONALI DI CONTROVENTAMENTO INFERIORI TRATTO A LARGHEZZA COSTANTE
PIANTA
scala 1:50

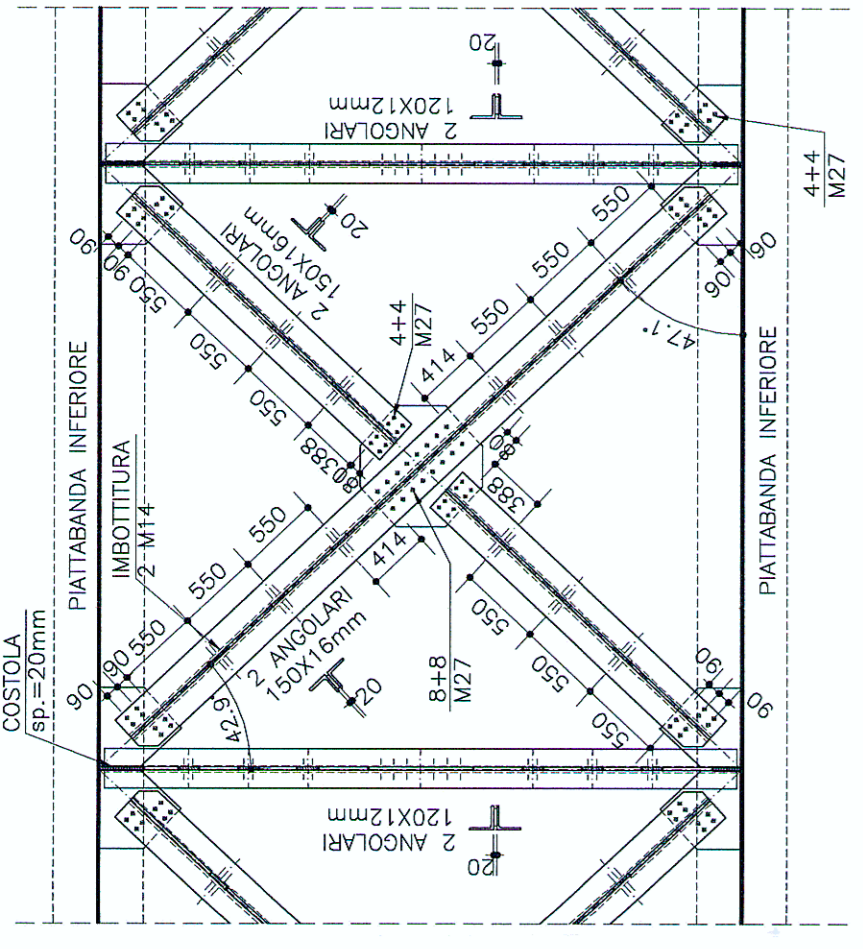

DIAGONALI DI CONTROVENTAMENTO SUPERIORI PILA P5
PIANTA
scala 1:50

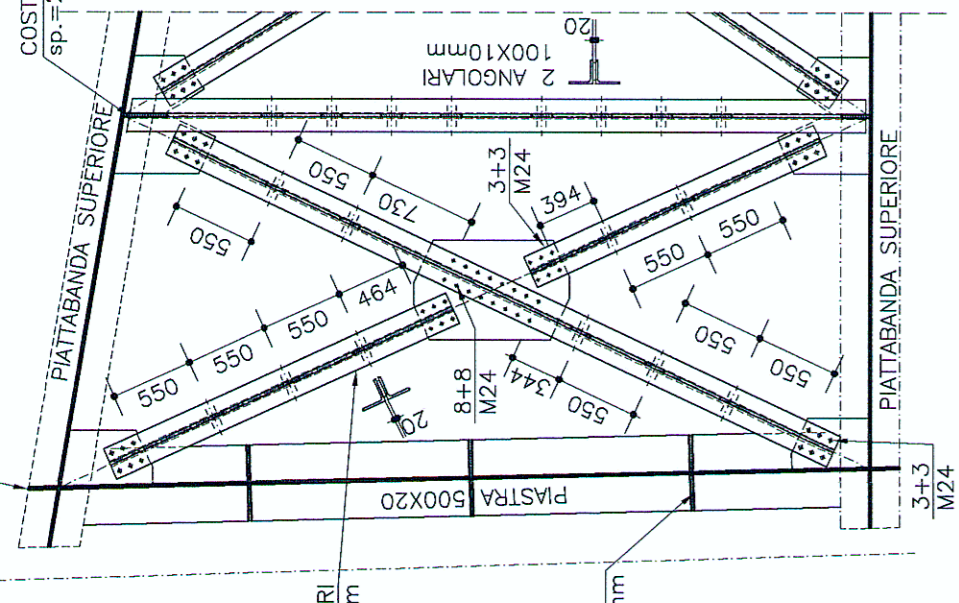

DIAGONALI DI CONTROVENTAMENTO INFERIORI PILA P5
PIANTA
scala 1:50

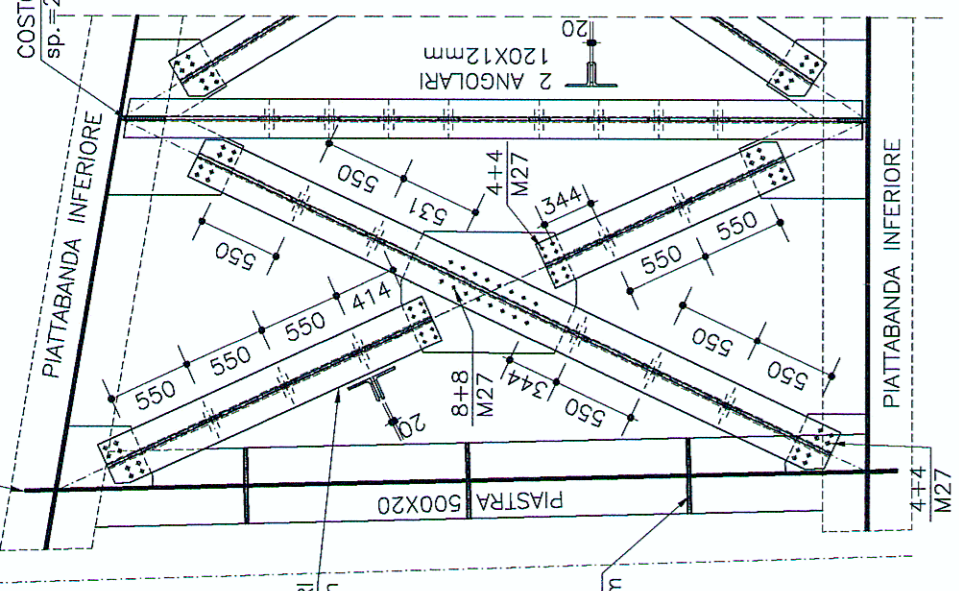

TRAVESSO INTERMEDIO TRATTO A LARGHEZZA COSTANTE
scala 1:20

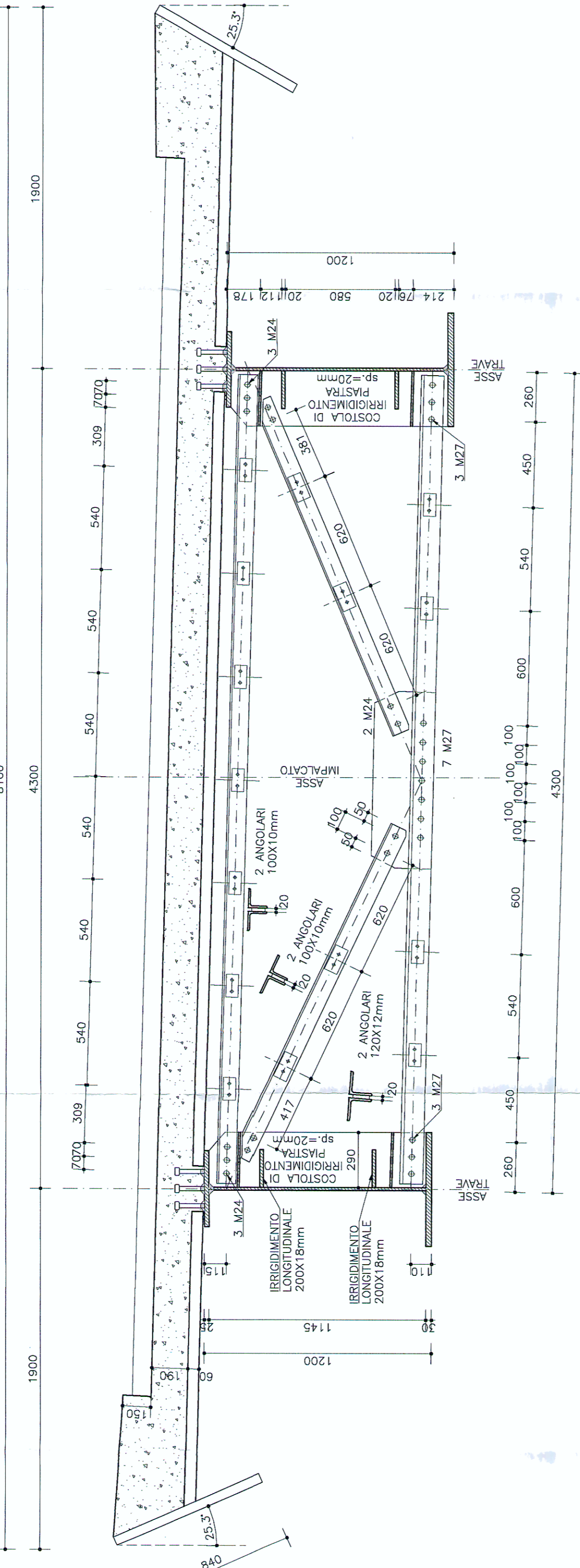

TRAVESSO DI TESTATA S2
scala 1:20

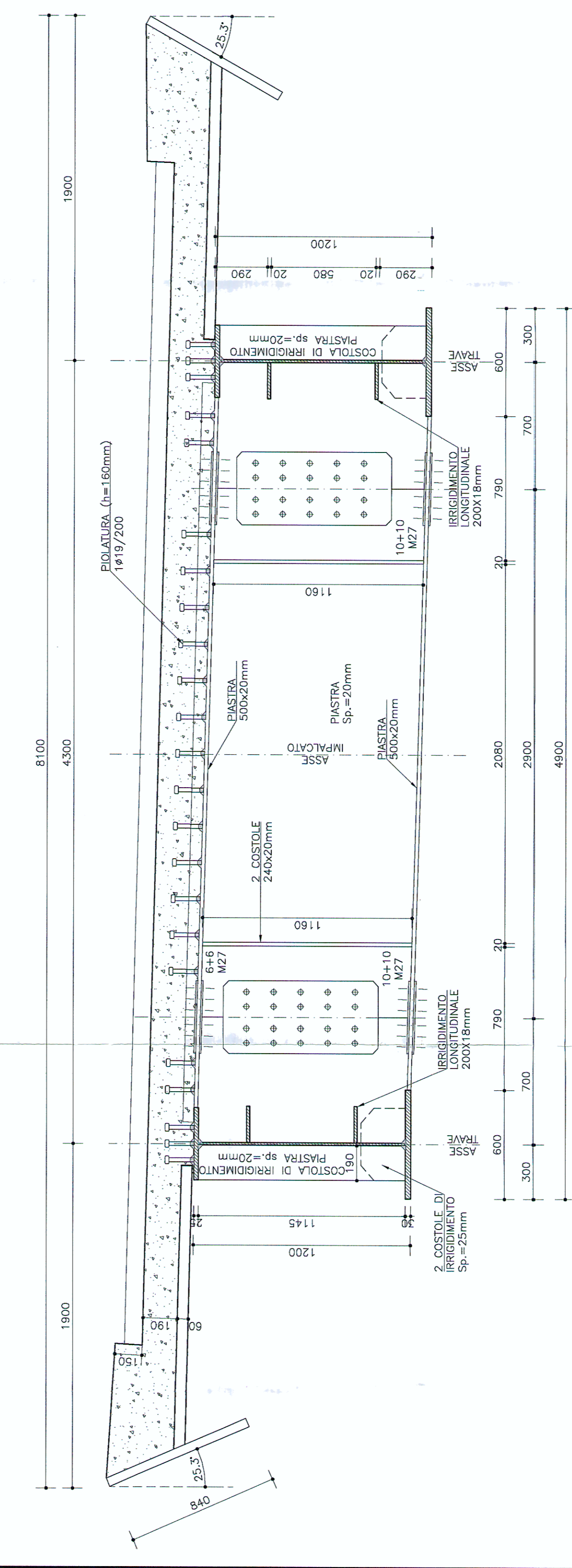

DIAFRAMMA PIENO PILA P6
scala 1:20

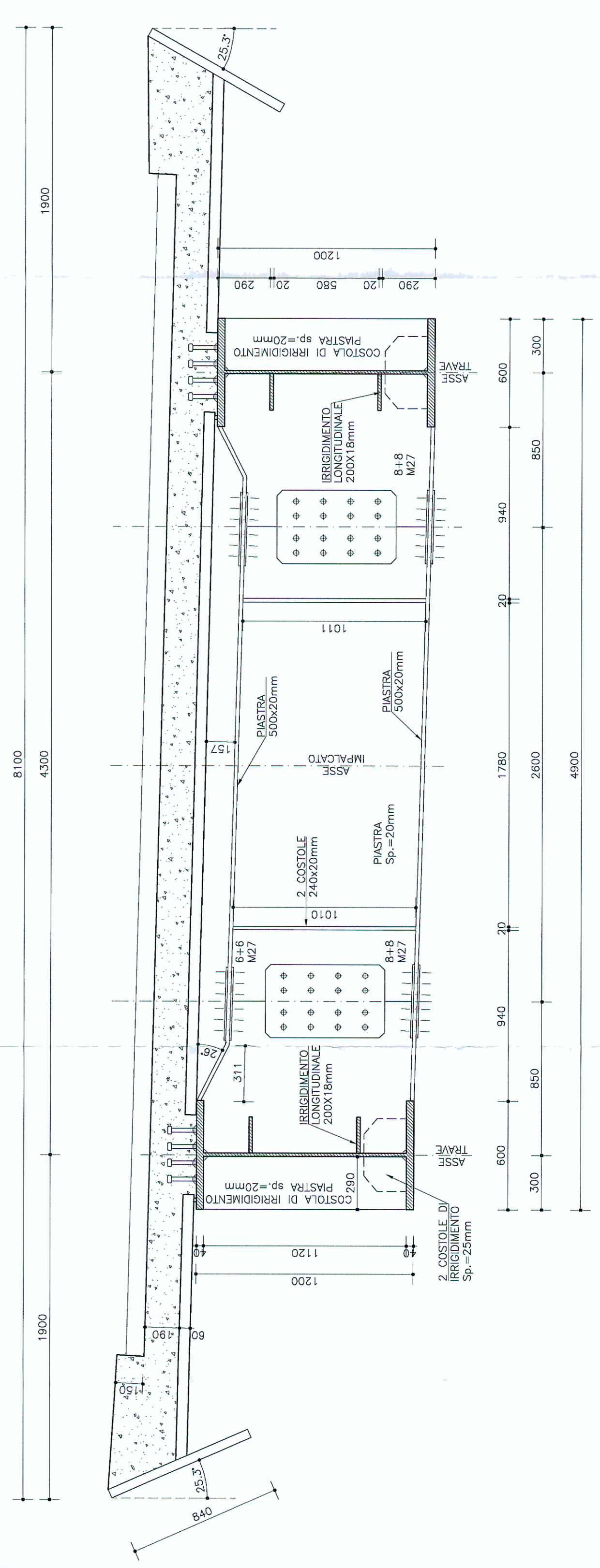

TRAVESSO DI TESTATA P5
scala 1:20

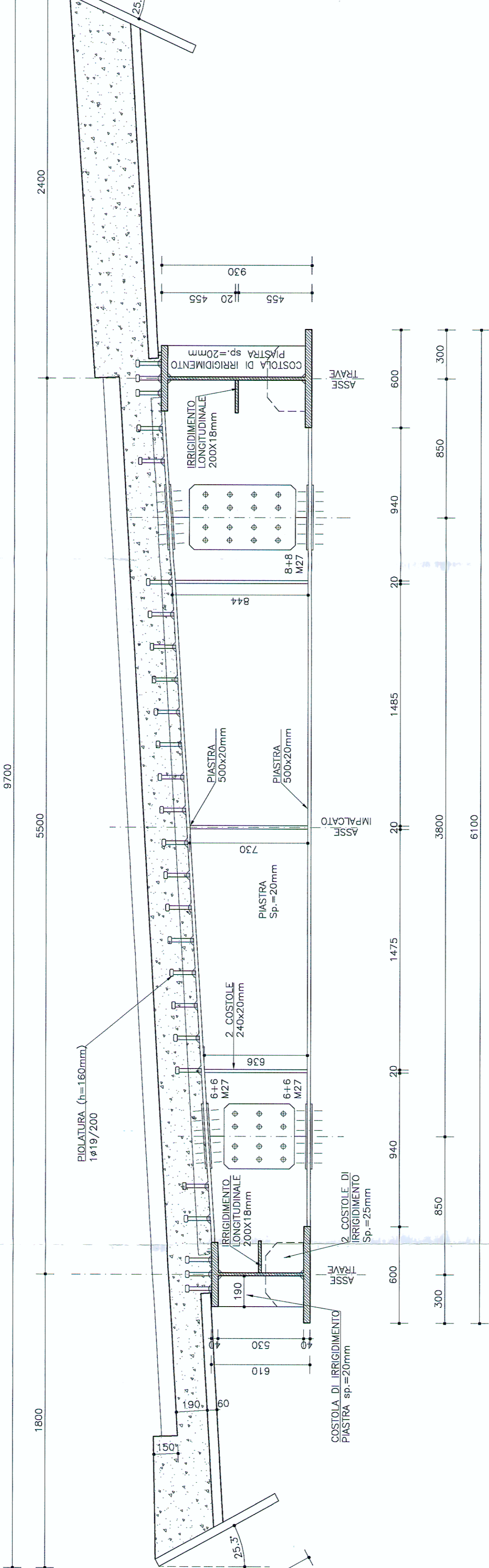

TRAVESSO INTERMEDIO TRATTO A LARGHEZZA VARIABILE
scala 1:20

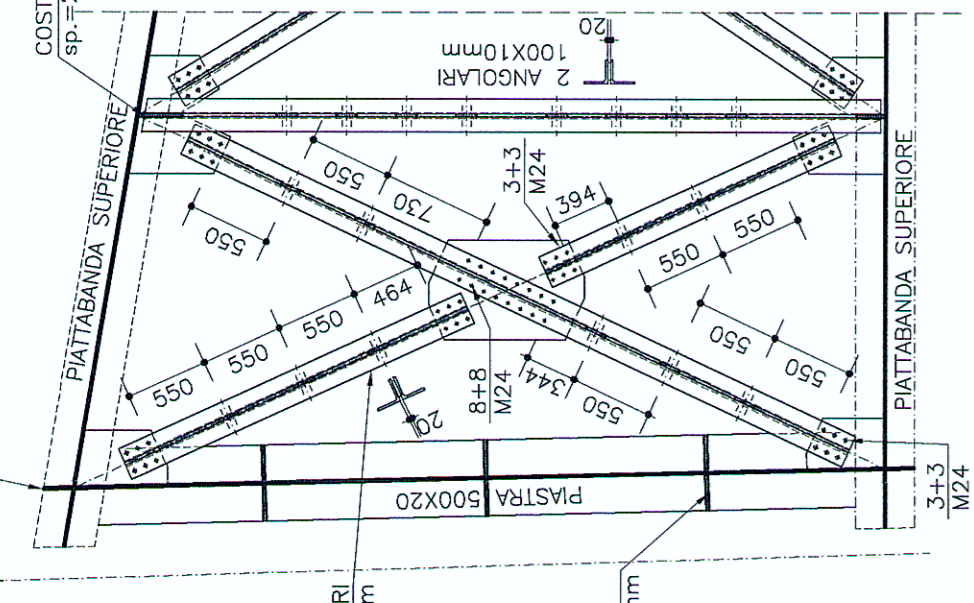
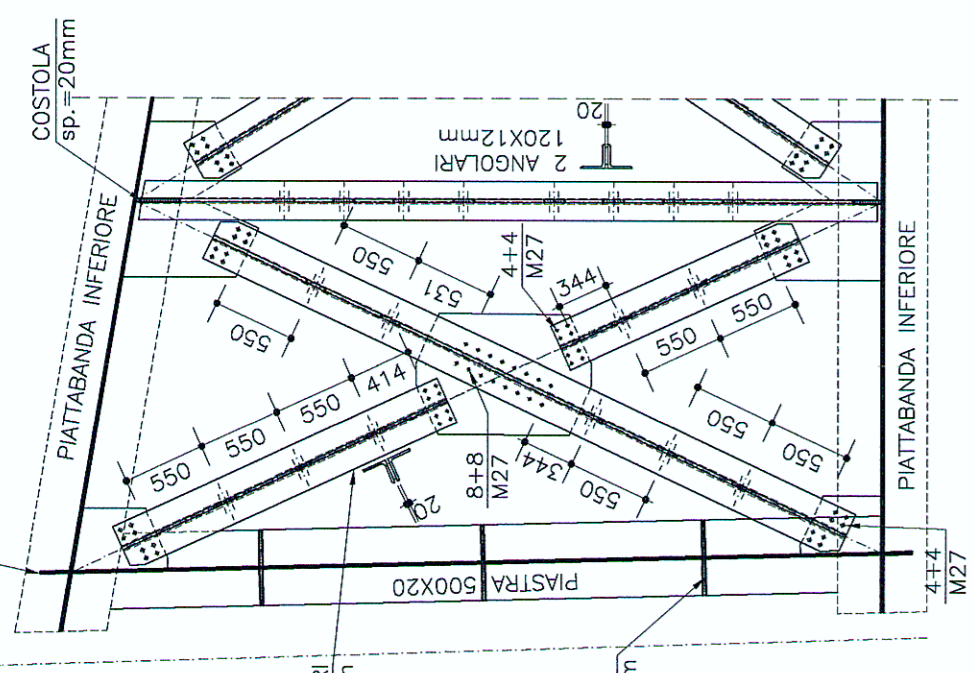
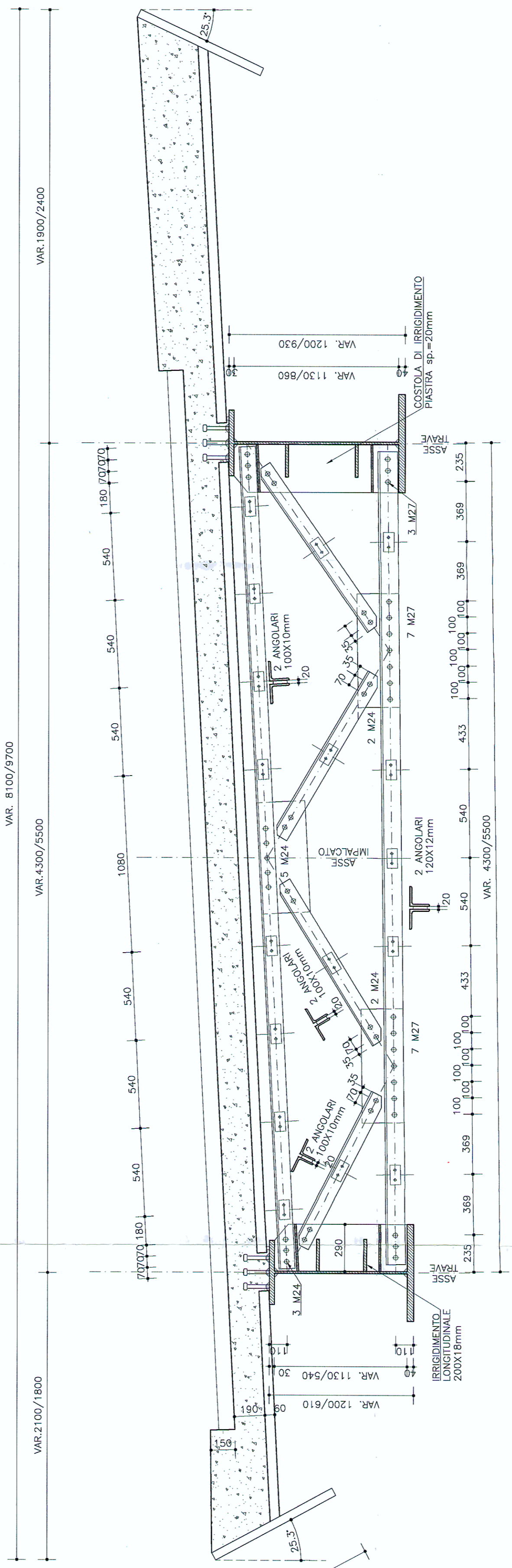

REFERENCES / REFERENCES
PROG. CA. M. S. - 1998 - PROVA DI CARICAMENTO
PROG. CA. M. S. - 1998 - PROVA DI CARICAMENTO
PROG. CA. M. S. - 1998 - PROVA DI CARICAMENTO
PROG. CA. M. S. - 1998 - PROVA DI CARICAMENTO
PROG. CA. M. S. - 1998 - PROVA DI CARICAMENTO

SOCIETA' ITALIANA
TRAFFICO AUTOSTRADALE DEL FREJUS
STAF
Società Ing. E. San Giuliano, E. - 40035 Sesto (LO)

RILOCALIZZAZIONE
DELL'AUTOPOSTO DI SUSÀ
SOVRAPPASSO DI USCITA - IMPALCATO RAMPA
B - TRAVERSI E CONTROVENTI

Descrizione	Autore	Data	Dimensione	Stampa	Area
PROGETTO	ING. E. SAN GIULIANO	01/10/2000	1:500/200		10.000
REDATTORE	ING. E. SAN GIULIANO	01/10/2000	1:500/200		10.000
VERIFICATO	ING. E. SAN GIULIANO	01/10/2000	1:500/200		10.000
CONTOGGIO	ING. E. SAN GIULIANO	01/10/2000	1:500/200		10.000
ESATTORE	ING. E. SAN GIULIANO	01/10/2000	1:500/200		10.000
CONTOGGIO	ING. E. SAN GIULIANO	01/10/2000	1:500/200		10.000
ESATTORE	ING. E. SAN GIULIANO	01/10/2000	1:500/200		10.000

Scale: 1:50 (Diagonals), 1:20 (Beams/Diaphragm), 1:50 (Reference)

Scale: 1:50 (Diagonals), 1:20 (Beams/Diaphragm), 1:50 (Reference)